



*Spree*

TRAVEL TRAILERS and FIFTH WHEELS



*A Change of Pace... A Change of Scene*



Helping You Get Away  
From It All Since 1972

# Spree

## Travel Trailers

Spacious from end-to-end, the expansive side slide out means you'll never be pinched for space. The wide windows of the living/dining area provide a great view. Decorator fabrics, coordinated window valances and blinds, and random plank-look linoleum add that special touch.

Storage isn't a problem... the look of leaded-glass graces the overhead cabinets and the entertainment cabinet effectively creates cozy privacy in the front bedroom while the kids enjoy dual bunks in the rear slide out.



The kitchen's upper cabinets and optional refrigerator door feature the classic beauty of raised panel doors.

Dual bunks, storage and privacy curtains give the kids a space of their own.

# 318BHS



Relax and enjoy a good night's rest.



At the end of a busy day, refresh yourself in this complete bath.



Here's a popular option – the dual bunks can be replaced by a comfy convertible sofa with a stow-away bunk above. The bunk easily drops down when needed and the sofa expands to create even more sleep space.



# 289KS



The large dinette quickly converts into a spacious bed.

An expansive king-sized bed and increased living area are the result of the large rear slide out.

Now you can take your big toys along!



Comfort and convenience are designed into this convertible sleep space/cargo bay. The bed is flanked by matching mirrored wardrobes with cargo-netted storage compartments above.



Shown with optional bedroom door ramp

The wide side-entry door ramp with extension makes loading and unloading a breeze.



The bed easily stows out of the way with gas assist lift arms.



# 323RLSLX



The 323RLS living and dining side slide out will provide you with the comforts of home. The entertainment center's location provides viewing from anywhere in the main coach.



Meal preparation is convenient and this easy-care linoleum features the rich look of random plank flooring.

The bedroom with its queen-size bed, is separated from the main living area by a spacious walk-thru bath.



Matching mirrored wardrobe doors and abundant overhead cabinets provide you with comfortable personal space.



# 285RL

# Spree

## Fifth Wheels

The all new Spree lightweight fifth wheel is engineered to provide everything that you would expect and more. From the full size slides to the expansive basement storage this aerodynamic lightweight can easily be towed by a half-ton truck.

The kitchen is just another example at KZ engineering. Functional, plenty of storage and all the warmth of home.

The best way to describe the Spree is spacious. There is plenty of warm comfortable seating room and a very open design so you'll never feel confined.

Matching mirrored wardrobe doors provide you with comfortable personal space.





Enjoy the privacy of your own master half-bath



Relax and enjoy the view in these cozy recliners. Another example of the roomy comforts the new Spree lightweight offers – no compromising here...





## Travel Trailer

|   | 210KS | 240BH | 240RL | 240RBS | 245KS | 255KS | 261RKS | 260RBS | 260FL  | 280RLS | 289KS | 290BHS | 318BHS | 323RLS | 324BHS |
|---|-------|-------|-------|--------|-------|-------|--------|--------|--------|--------|-------|--------|--------|--------|--------|
| <b>UVW</b> (Unloaded Vehicle Wt.)         | 3821  | 4169  | 3819  | 4242   | 4659  | 4474  | 4882   | 5057   | 5224   | 5145   | 5028  | 5450   | 5577   | 5357   | 5570   |
| <b>Dry Hitch Wt.</b>                      | 460   | 509   | 584   | 432    | 562   | 504   | 467    | 552    | 799    | 636    | 450   | 639    | 708    | 558    | 653    |
| <b>Dry Axle Wt.</b>                       | 3361  | 3687  | 3819  | 3810   | 4359  | 3970  | 4677   | 4505   | 4425   | 4771   | 4578  | 4811   | 4869   | 4799   | 4917   |
| <b>NCC</b> (Net Carrier Capacity)         | 1679  | 1831  | 1681  | 1758   | 1841  | 2026  | 1918   | 1743   | 1776   | 1855   | 1972  | 1550   | 1923   | 2143   | 1930   |
| <b>GVWR</b>                               | 5500  | 6000  | 5500  | 6000   | 6500  | 6500  | 6800   | 6800   | 7000   | 7000   | 7000  | 7000   | 7500   | 7500   | 7500   |
| <b>Interior Height</b>                    | 78"   | 78"   | 78"   | 78"    | 78"   | 78"   | 78"    | 78"    | 78"    | 78"    | 78"   | 78"    | 78"    | 78"    | 78"    |
| <b>Exterior Height</b>                    | 10'3" | 10'3" | 10'3" | 10'3"  | 10'3" | 10'3" | 10'9"  | 10'9"  | 10'9"  | 10'9"  | 10'3" | 10'9"  | 10'9"  | 10'9"  | 10'9"  |
| <b>Exterior Width</b>                     | 96"   | 96"   | 96"   | 96"    | 96"   | 96"   | 96"    | 96"    | 96"    | 96"    | 96"   | 96"    | 96"    | 96"    | 96"    |
| <b>Exterior Length</b>                    | 23'4" | 26'9" | 26'5" | 26'9"  | 26'2" | 28'1" | 28'4"  | 28'8"  | 28'10" | 29'2"  | 30'6" | 31'3"  | 32'9"  | 32'1"  | 33'7"  |
| <b>Refrigerator</b> (cu. feet)            | 6     | 6     | 6     | 6      | 6     | 6     | 6      | 6      | 6      | 6      | 6     | 6      | 6      | 6      | 6      |
| <b>Water Heater Cap.</b> (gal. G/E w/DSI) | 6     | 6     | 6     | 6      | 6     | 6     | 6      | 6      | 6      | 6      | 6     | 6      | 6      | 6      | 6      |
| <b>Fresh Water Cap.</b> (gal.)            | 40    | 40    | 40    | 40     | 40    | 40    | 40     | 40     | 40     | 40     | 40    | 40     | 40     | 40     | 40     |
| <b>Waste Water Cap.</b> (gal.)            | 32    | 32    | 32    | 32     | 32    | 32    | 32     | 32     | 32     | 32     | 32    | 32     | 32     | 32     | 32     |
| <b>Gray Water Cap.</b> (gal.)             | 32    | 32    | 32    | 32     | 32    | 32    | 32     | 32     | 32     | 32     | 32    | 32     | 32     | 32     | 32     |
| <b>LP Gas Cap.</b> (lbs.)                 | 60    | 60    | 60    | 60     | 60    | 60    | 60     | 60     | 60     | 60     | 60    | 60     | 60     | 60     | 60     |
| <b>Furnace BTUs</b> (1,000's)             | 20    | 20    | 20    | 20     | 20    | 20    | 20     | 20     | 20     | 25     | 25    | 25     | 30     | 30     | 30     |
| <b>Tire Size</b>                          | 15"   | 15"   | 15"   | 15"    | 15"   | 15"   | 15"    | 15"    | 15"    | 15"    | 15"   | 15"    | 15"    | 15"    | 15"    |
| <b>Awning</b>                             | 14'   | 17'   | 14'   | 14'    | 14'   | 16'   | 15'    | 16'    | 13'    | 15'    | 15'   | 14'    | 14'    | 16'    | 17'    |

## Custom Mandatory Package (FORCED OPTION)

- 13,500 Ducted BTU A/C
- Awning
- Microwave w/Turn Table
- 6 Cu. Double Door Refer
- Straight Axles
- Skylight Over Tub
- Tub Surround
- Porch Light on ODS
- Hitch Light
- Cable Hook-Up
- Oven
- Night Shades
- Black Glass Refer Front
- AM/FM CD Player \*
- AM/FM DVD w/surround sound \*
- 6 Gallon Gas/Electric DSI Water Heater
- 15" Tires
- Sink Cover
- Exterior Shower
- Stabilizer Jacks (4xTT's & 2xFW's)
- Black Tank Flush System
- Raised Panel Bathroom Door
- Tinted/Safety Windows
- Trash Bin
- Power Jacks on FW's
- Enclosed Pin Box on FW's

\*available on selected units

## LX Package

- (All of the Custom Package)
- Aluminum Wheels
- Fiberglass Front Cap on TT only
- Assist Grab Handle
- Raised Panel Refer Door
- Foot Flush Toilet
- LCD Flat Screen TV

## Additional Options

- Countertop Extension (Extra large) (n/a on 210KS, 240BH, 240RBS, 240RL, 255KS)
- Fantastic Fan
- Outside Grill
- Side Ramp Door (255KS & 289KS) (includes Tuff Ply on Door and Floor)
- Ramp Door Extension
- Pull Down Screen Wall (255KS & 289KS)
- Spare Tire, Carrier & Cover
- Hide-A-Bed (available on 260RBS, 280RLS, 290BHS, 318BHS, 323RLS, 324BHS, 265RL & 285RL)
- 15,000 BTU A/C
- LCD Flat Screen TV
- Power Awning
- Jiffy Sofa w/Flip Up Bunk (318BHS)

## Because it Rains!



Here at K-Z we know a little bit about camping, actually we know a lot about camping. One thing you can count on, it will rain. We randomly test our K-Z campers from every product line in our state of the art rain booth. The rain may spoil your fun outside, but it won't inside.



Another KZ standard – newly designed drip rails and spouts keep the water flowing away from the sidewalls.



Total  
Aluminum  
Frame

## Fifth Wheels

| 265RL | 285RL  | 305BH  |
|-------|--------|--------|
| 5845  | 5843   | 7113   |
| 879   | 1047   | 1281   |
| 5002  | 4796   | 5832   |
| 1655  | 1657   | 1687   |
| 7500  | 7500   | 8800   |
| 91"   | 91"    | 91"    |
| 11'9" | 11'11" | 11'9"  |
| 96"   | 96"    | 96"    |
| 28'2" | 29'7"  | 33'10" |
| 6     | 6      | 6      |
| 6     | 6      | 6      |
| 40    | 40     | 40     |
| 32    | 32     | 32     |
| 32    | 32     | 32     |
| 60    | 60     | 60     |
| 30    | 30     | 30     |
| 15"   | 15"    | 15"    |
| 12'   | 18'    | 18'    |

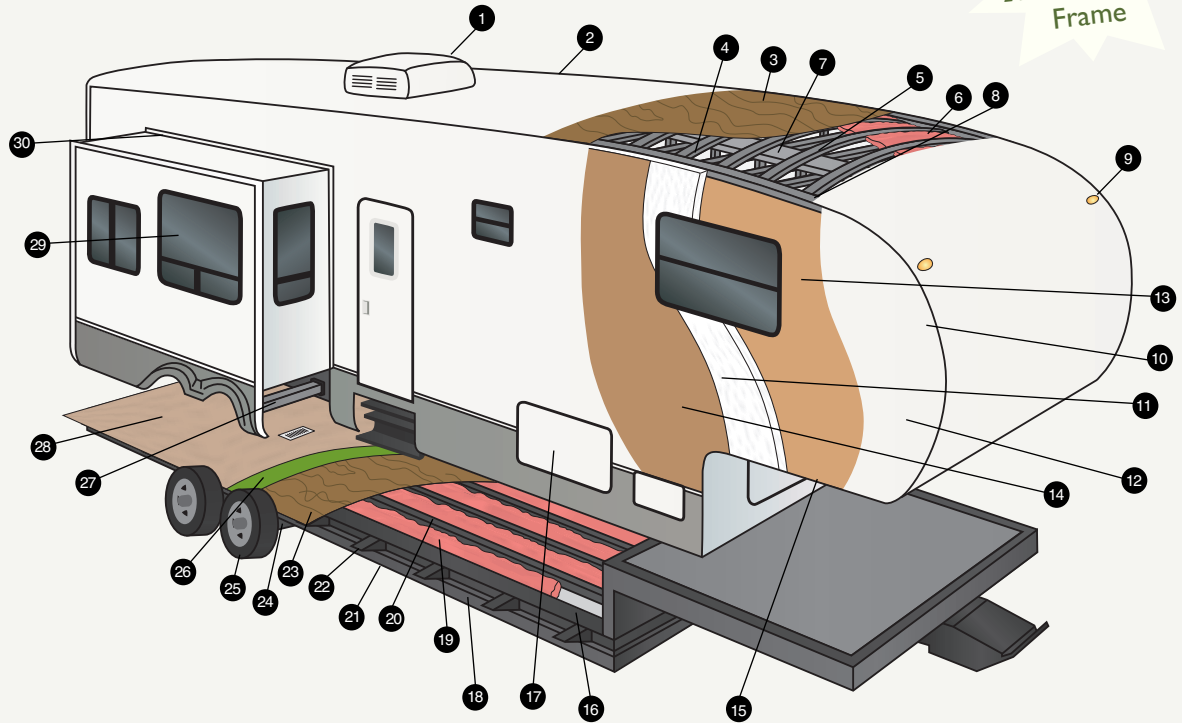

## Cut-Away Features

- 1 13,500 BTU A/C
- 2 TPO Vinyl Roof
- 3 1/4" Luan (fully walk on)
- 4 Vinyl Interior Ceiling Panel
- 5 4 1/2" Aluminum Truss Rafters, 16" O.C.
- 6 R-7 Batten Insulation
- 7 Insulated Ductwork
- 8 Heavy Duty Aluminum Headers
- 9 Exterior Clearance and Brake Lights
- 10 Aluminum Frame Front and End Walls
- 11 Expanded Polystyrene - R7
- 12 Fiberglass Exterior with Integrated Luan Backing
- 13 1/8" Luan Decorative Wall Board
- 14 1/8" Luan
- 15 3" Aluminum Stringer
- 16 Darco<sup>®</sup> Moisture Barrier
- 17 Large Capacity Pass-Thru Exterior Storage with Radius Doors Front and Side for Easy Access
- 18 Heavy Duty I-beam Frame Construction
- 19 R-7 Batten Insulation
- 20 2x2 Double Welded Aluminum Floor Joists, 16" O.C.
- 21 Heated & Enclosed Underbelly
- 22 Fully Welded Outriggers
- 23 Plywood Floor
- 24 Heavy Duty Leaf Springs
- 25 Heavy Duty Steel Wheels
- 26 Residential Style Carpet Pad
- 27 Rack and Pinion Electric Slide with Manual Override with Box Tube Slide Out Ram
- 28 28 oz. Residential Carpet or Linoleum
- 29 Tinted Safety Glass Windows
- 30 Triple Sealed Slide Outs

Wall Cut-Away

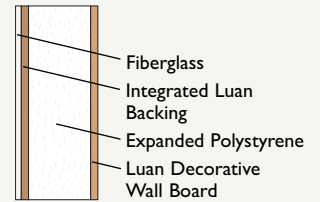

## Décor Selections

### Chestnut



### Indigo





# Travel Trailer Floor Plans

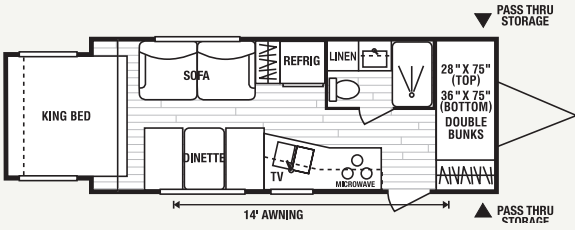

**210KS** • UVW 3821 • Dry Hitch Wt. 460 • NCC 1679 • Length 23'4"

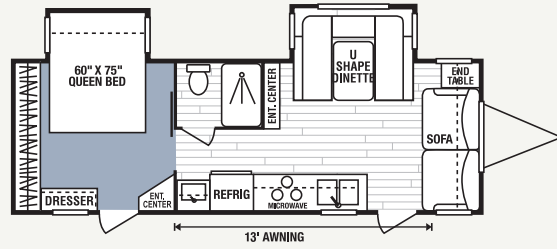

**260FL** • UVW 5224 • Dry Hitch Wt. 799 • NCC 1776 • Length 28'10"

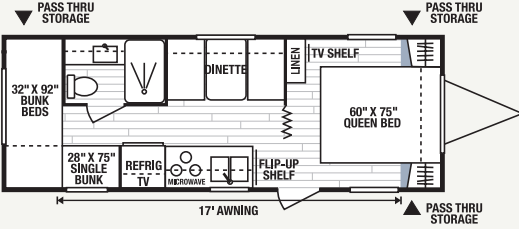

**240BH** • UVW 4169 • Dry Hitch Wt. 509 • NCC 1831 • Length 26'9"

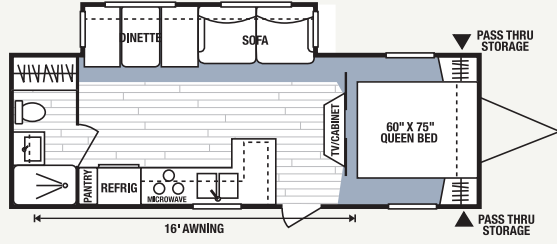

**260RBS** • UVW 5057 • Dry Hitch Wt. 552 • NCC 1743 • Length 28'8"

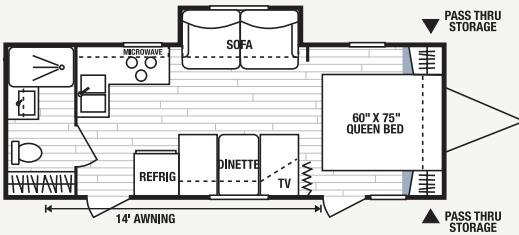

**240RBS** • UVW 4242 • Dry Hitch Wt. 432 • NCC 1758 • Length 26'9"

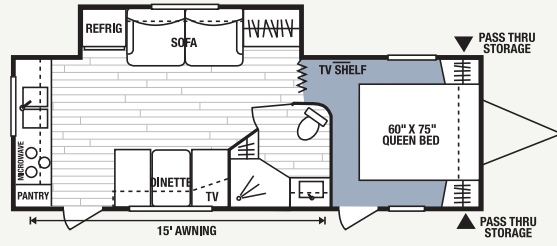

**261RKS** • UVW 4882 • Dry Hitch Wt. 467 • NCC 1918 • Length 28'4"

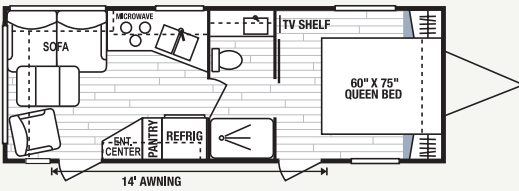

**240RL** • UVW 3819 • Dry Hitch Wt. 584 • NCC 1681 • Length 26' 5"

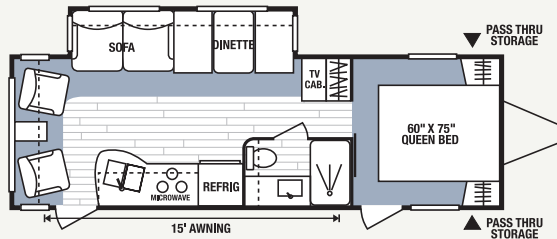

**280RLS** • UVW 5145 • Dry Hitch Wt. 636 • NCC 1855 • Length 29'2"

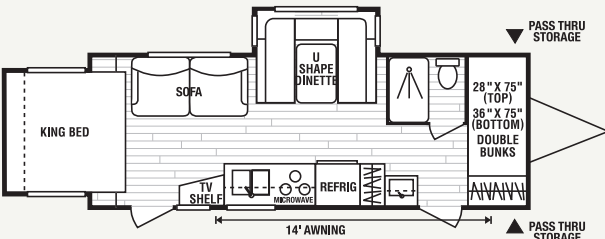

**245KS** • UVW 4659 • Dry Hitch Wt. 562 • NCC 1841 • Length 26'2"

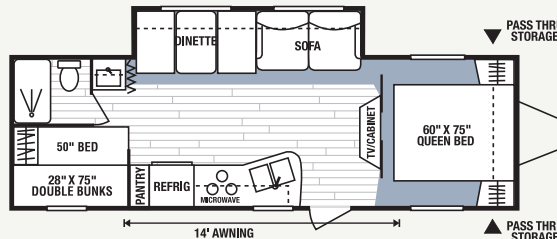

**290BHS** • UVW 5450 • Dry Hitch Wt. 639 • NCC 1550 • Length 31'3"

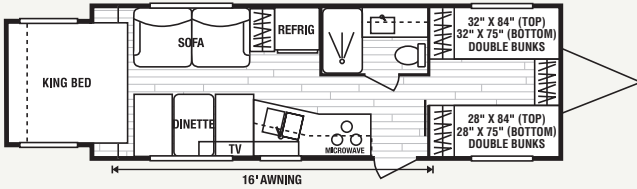

• see ramp door option

**255KS** • UVW 4474 • Dry Hitch Wt. 504 • NCC 2026 • Length 28'1"

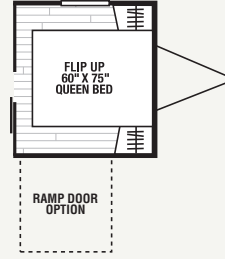

**255KS & 289KS** • Ramp Door Opt.

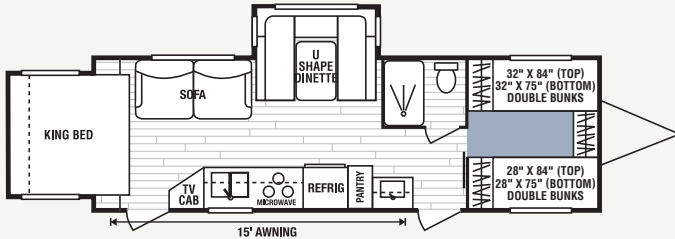

• see ramp door option

**289KS** • UVW 5028 • Dry Hitch Wt. 450 • NCC 1972 • Length 30'6"



**318BHS** • Sofa/Flip Up Bunk Opt.

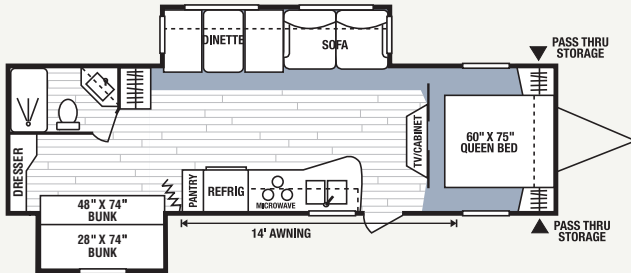

**318BHS** • UVW 5577 • Dry Hitch Wt. 708 • NCC 1923 • Length 32'9"

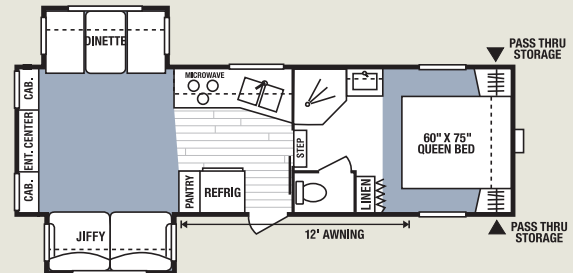

**265RLS** • UVW 5845 • Dry Hitch Wt. 879 • NCC 1655 • Length 28'2"

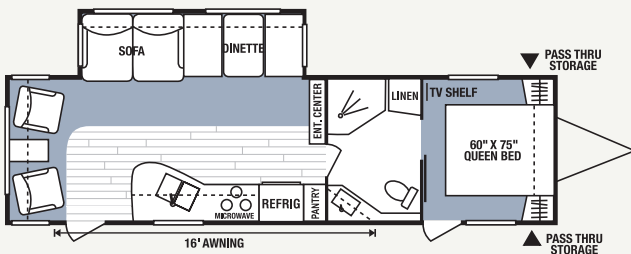

**323RLS** • UVW 5357 • Dry Hitch Wt. 558 • NCC 2143 • Length 32'1"

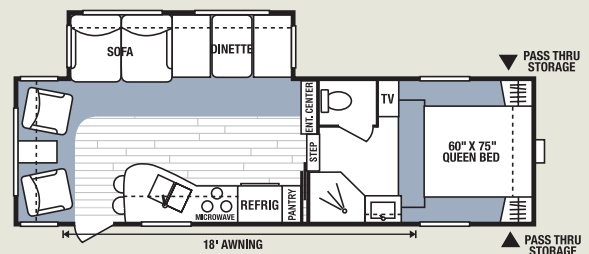

**285RLS** • UVW 5843 • Dry Hitch Wt. 1047 • NCC 1657 • Length 29'7"

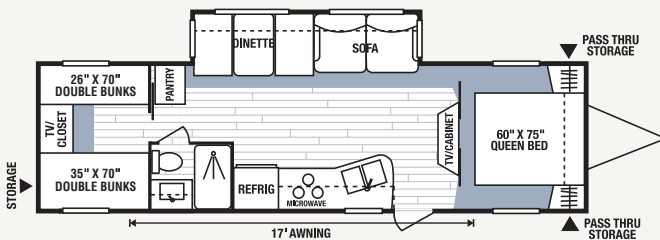

**324BHS** • UVW 5570 • Dry Hitch Wt. 653 • NCC 1930 • Length 33'7"

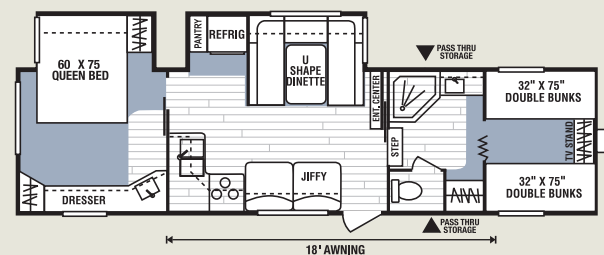

**305BH** • UVW TBA • Dry Hitch Wt. TBA • NCC TBA • Length TBA

## Fifth Wheel Floor Plans

**2X2 WARRANTY** – The K-Z 2x2 Warranty is a manufacturer's warranty. Each K-Z product is warranted to the original purchaser for twenty-four (24) months from the original date of purchase. Coverage includes appliances, components, construction and FULL structure. Our warranty is also transferable within the first two (2) years for a small processing fee. For a copy of the warranty with full terms and conditions, ask your local K-Z Dealer or visit our web site at <http://www.kz-rv.com>.

**VEHICLE LOADING** – Every effort has been made to provide the greatest number of options for the recreation vehicle owner. Each owner is responsible to select loads allowing the recreational vehicle to remain within the manufacturer's specified chassis weight limits. Do not overload the recreational vehicle.

**UNLOADED VEHICLE WEIGHT (UVW)** – The typical weight of this trailer as built at the factory. The UVW does not include cargo, LP gas, fresh water, options or dealer-installed accessories.

**GROSS VEHICLE WEIGHT RATING (GVWR)** – The maximum permissible weight of the trailer, including the UVW plus passengers, all cargo, personal items, fluids, options and dealer-installed accessories. The GVRW is equal to or greater than the sum of the UVW and the NCC.

**NET CARRYING CAPACITY (NCC)** – The maximum weight of all passengers, personal items, fresh water, food, tools, LP gas, other cargo and dealer-installed accessories\* that can be carried by the trailer. NCC is equal to or less than GVWR minus UVW.

\* The addition of options will decrease the NCC.

It is important for your safety and enjoyment that your tow vehicle be adequately sized and equipped to tow and handle the GVWR of the RV you select. Review weights and rating of your tow vehicle and consult a competent advisor for questions or advice. Whether you are new to RVing or a seasoned veteran, get a feel for the performance of your tow vehicle and the RV together before heading out on the roadways. When you tow an RV, you must drive differently than you do when driving a single vehicle. Practice hooking up, driving, backing up and braking in a safe environment or seek out professional instruction.

See specification chart above. K-Z affixes a weight label to each new RV which lists weight information for that vehicle.

**NOTE:** This information is intended as a guide only. Weights of individual vehicles are approximate. Consult your Owner's Manual for complete loading, weighing and towing instructions. All weights may vary.

Awarded to K-Z  
six years in a row.



K-Z • 0985 N 900 W • Shipshewana, IN 46565  
E-Mail [kz@kz-rv.com](mailto:kz@kz-rv.com) • [www.kz-rv.com](http://www.kz-rv.com)

Due to continual research and advances, manufacturer reserves the right to change specifications, design, price and equipment without notice, and assumes no responsibility for any error in this literature. Some items shown are not included as standard or optional equipment.  
©2007K-Z

1/1/08 25M

**Dealer:**

