



DURANGO

1500



Come home to KZ!

www.kz-rv.com



D326RE Shown in
Bamboo Décor

DURANGO

1500

Light weight and beautifully appointed, there's a model just right for you.



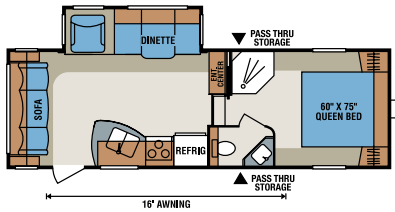

D245RL

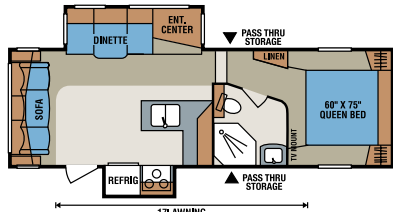

D245SB • Wardrobe Closet Slide Option – see below

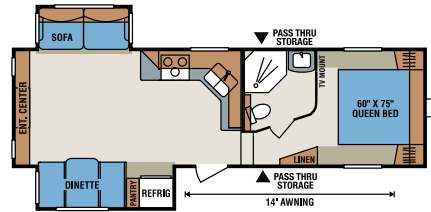

D275RE

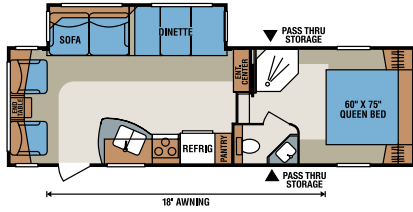

D275RL • Wardrobe Closet Slide Option – see below

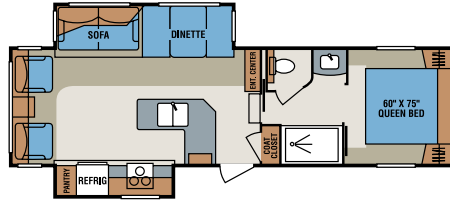

D2857

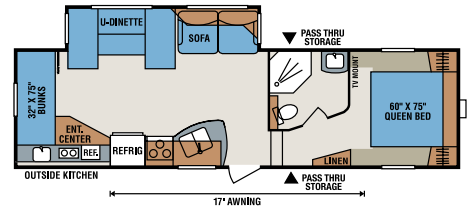

D295BH

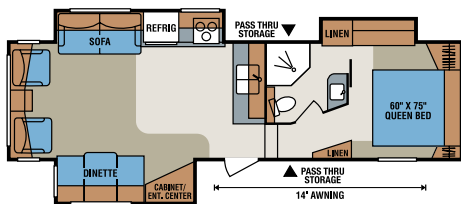

D295CS

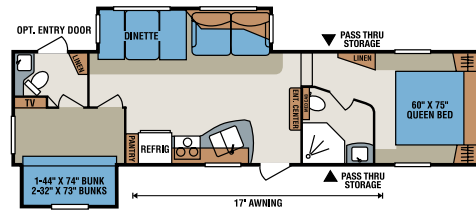

D296BH

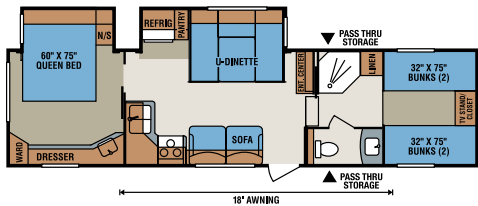

D305BH

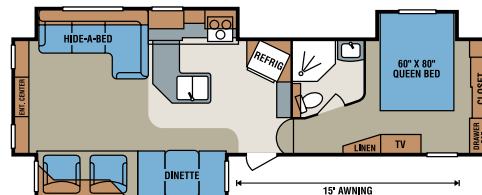

D326RE

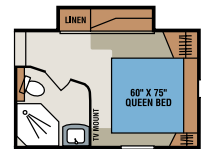

D245SB
Wardrobe Closet Slide Option

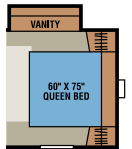

D275RL
Wardrobe Closet Slide Option

1500 FIFTH WHEELS	D245RL	D245SB	D275RE	D275RL	D2857	D295BH	D295CS	D296BH	D305BH	D326RE
UVW (Unloaded Vehicle Weight)*	6,600	7,153	7,258	7,158	8,220	7,475	8,128	8,158	8,102	9,080
Dry Hitch Weight*	1,320	1,317	1,206	1,105	1,170	1,325	1,375	1,208	1,305	1,720
Dry Axle Weight*	5,280	5,836	6,052	6,053	7,050	6,150	6,753	6,950	6,797	7,360
NCC (Net Carrying Capacity)	2,200	1,647	1,542	1,642	1,780	1,325	1,672	1,642	1,698	1,720
GVWR	8,800	8,800	8,800	8,800	10,000	8,800	9,800	9,800	9,800	10,800
Exterior Height	143"	144"	143"	143"	144"	144"	144"	145"	144"	144"
Exterior Width	96"	96"	96"	96"	96"	96"	96"	96"	96"	96"
Exterior Length	27' 3"	27' 11"	29' 8"	29' 4"	31' 8"	31' 9"	31' 11"	33' 11"	34' 1"	34' 5"
Refrigerator (cu. feet)	6	6	6	6	6	6	6	6	6	6
Water Heater Cap. (gal. G/E w/DSI)	6	6	6	6	6	6	6	6	6	6
Fresh Water Cap. (gal.)	55	55	55	55	55	55	55	55	55	55
Waste Water Cap. (gal.)	32	32	32	32	32	32	32	32	32	32
Gray Water Cap. (gal.)	32	32	32	32	32	32	32	32	32	32
LP Gas Cap. (lbs.)	60	60	60	60	60	60	60	60	60	60
Furnace BTUs (1,000s)	30	30	30	30	30	30	30	30	30	30
Tire Size	15"	15"	15"	15"	15"	15"	15"	15"	15"	15"
Awning	16'	16'	14'	18'	15'	17'	14'	17'	18'	15'

*This weight reflects the rolling average unit weight for each model. Your trailer weight will vary according to optional equipment.

2012 Durango 1500 Cut-Away



Coach-Net®

RV Membership Plans

One Year **FREE**
Road Side Assistance
courtesy of KZ!

- | | | |
|---|--|---------------------------------------|
| 1 13,500 BTU A/C | 17 Large capacity pass-thru storage with bus style slam latch doors | 32 Exterior security/Scare lights |
| 2 1 piece seamless roofing material | 18 Heavy duty I-beam frame construction | 33 Snap jacks pull pins |
| 3 3/8" decking | 19 R-7 batten insulation | 34 Extra long drip spouts |
| 4 Vinyl interior ceiling panel | 20 2x3 floor joist, 16" O.C. | 35 Satellite preparation |
| 5 4 3/8" truss rafter, 16" O.C. | 21 Heated & enclosed underbelly | 36 Exterior speakers |
| 6 R-14 batten insulation | 22 Insulated and heated water tanks | 37 Dexter NEV-R-ADJUST™ Brakes |
| 7 Insulated ductwork | 23 Fully welded outriggers | |
| 8 Exterior clearance and brake lights | 24 5/8" tongue & groove plywood | |
| 9 One-piece fiberglass front cap | 25 Heavy duty leaf springs | |
| 10 Expanded Polystyrene – R-9 | 26 Heavy duty steel wheels | |
| 11 Fiberglass exterior with integrated luan backing | 27 Residential style carpet pad | |
| 12 1/8" luan decorative wall board | 28 Rack and pinion electric slide with manual override with 2x2 tube slide out ram | |
| 13 1/8" luan wall board | 29 Residential carpet or linoleum | |
| 14 3" aluminum framed sidewall | 30 Tinted safety glass windows | |
| 15 Residential style ducted heat run in floor | 31 Triple sealed slide outs | |
| 16 Darco® moisture barrier | | |





D326RE

The visual appeal of raised panel, glazed finish, cabinetry is key to this attractive interior. Shown in Bamboo décor with standard 32" LCD TV and large solid surface countertops.



D2857 Features a comfortable living room and convenient walk-thru bath. Shown in 40th Anniversary Special Ruby décor.



Bamboo Décor



Basil Décor



Walnut Décor

Standards

- Eurodynamic Front Cap
- Stabilizer Jacks
- Awning with Drip Rail and Spouts
- Microwave with Turn Table
- 13,500 BTU Ducted A/C
- Enclosed Pin Box
- Security Light
- 6 Gallon Gas/Electric DSI Water Heater
- Skylight Over Tub
- Pillows for Sofa
- Wire for Satellite
- Heated Tanks and Enclosed Underbelly
- Tinted Windows
- Black Tank Flush System
- Power Jacks
- 6 Cubic Foot Refrigerator with Raised Panel Wood Insert

- 32" LCD TV
- Assist Grab Handle
- Night Shades
- AM/FM/CD/DVD Player with USB Port
- Porcelain Toilet
- Outside Speakers
- Innerspring Mattress
- Roller Ball Bearing Drawer Guides
- Dexter **NEV-R-ADJUST™** Brakes
- Gas Struts on Bed Base
- Outside Shower
- Bus Style Slam Latch Baggage Doors
- Decorative Light Above Dinette
- Solid Surface Countertops

Options

- Partial Paint Package
- Solid Surface Countertop Extension
- Hide-A-Bed (Forced on D326RE)
- Table and Chairs with Leaf
- Recliner – 1 or 2
- 2 Barrel Chairs IPO Sofa (D245SB Only)
- 8 Cubic Foot Refrigerator
- Fireplace (N/A on D275RL)
- Dyson® Vacuum
- Fan-Tastic Vent® (Bedroom and Bathroom)
- 15,000 BTU A/C (IPO 13,500 BTU A/C)
- Ladder
- Power Awning
- Aluminum Wheels
- Bike Rack/Cargo Tray
- Dexter E-Z Flex® Heavy Duty Rubber Suspension
- Outside Grill

- Spare Tire/Carrier/Cover
- Sidewinder Hitch
- Wardrobe Slide (D245SB and D275RL Only)
- Flip Up Bunk with Jiffy (D296BH Only)
- Entry Door in Bathroom (D296BH Only)
- Katching ZZ's Mattress Upgrade
- Large U-Shape Dinette (IPO Sofa and Dinette)

Road Trip Package

- Aluminum Wheels
- Dexter E-Z Flex® Heavy Duty Rubber Suspension
- Spare Tire/Carrier/Cover
- Ladder
- Power Awning
- 8 Cubic Foot Refrigerator
- Innerspring Mattress



Bike Rack



Cargo Carrier

The optional Bike Rack/Cargo Carrier offers you even greater versatility for those “extra” items you don’t want to leave at home.



Optional
Dyson®
Vac

ASK ABOUT OUR 2-YEAR LIMITED WARRANTY!



Dealer Satisfaction Index:
Ratings of manufacturers, by dealers, have consistently awarded KZ top honors for excellence of design, reliability, overall quality and value, communications and dealer support.

Dealer: _____



Portions of this brochure were used with the expressed authority of Dexter Axle, but Dexter Axle is not responsible for the accuracy of the information contained herein.

For more product details and in-depth information, visit us on the web at **www.kz-rv.com**

0985 N 900 W • Shipshewana, IN 46565
E-mail kz@kz-rv.com • www.kz-rv.com

Due to continual research and advances, manufacturer reserves the right to change specifications, design, price and equipment without notice, and assumes no responsibility for any error in this literature. Some items shown are not included as standard or optional equipment.