

# MXI



Lightweight Travel Trailer Toy Haulers





**MXT303**  
Zorro Décor with Cognac Maple

MXT is perfect for all your toy-hauling adventures with its long list of standards and options. Featuring 10 feet of cargo length, large U-dinette and queen size bed, **MXT303** offers ample toy storage plus plenty of sleeping space.



**MXT303** Zorro Décor with Cognac Maple



**MXT303** Zorro Décor Optional Sit'n Sleep



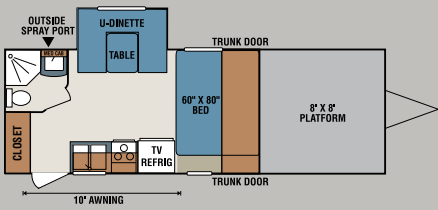

CRC170

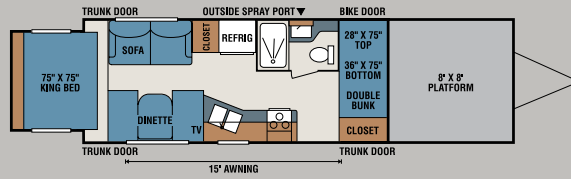

CRC210KS

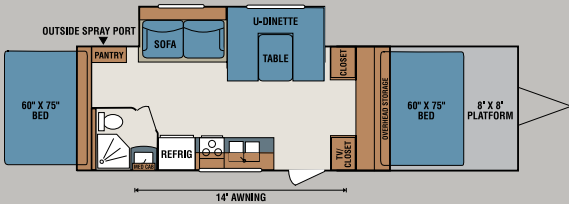

CRC222

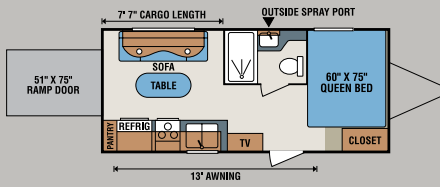

MXT160

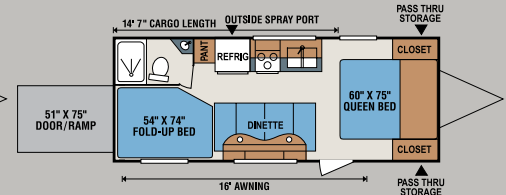

MXT20

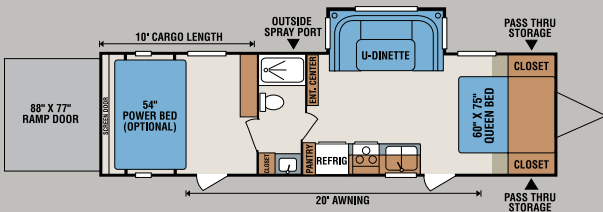

MXT303

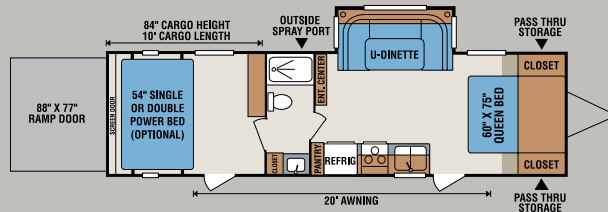

MXT309

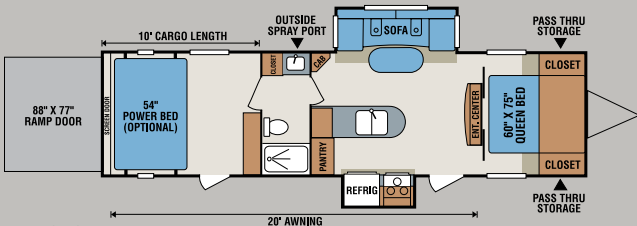

MXT312

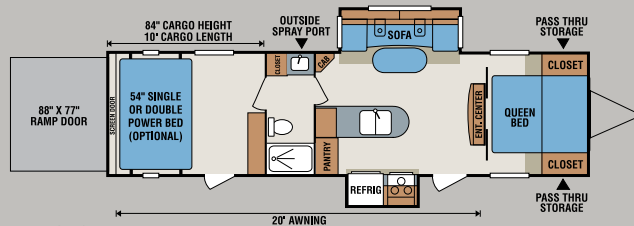

MXT319

Lightweight Travel Trailer Toy Haulers	CRC170	CRC210KS	CRC222	MXT160	MXT20	MXT303	MXT309	MXT312	MXT319
UVW (Unloaded Vehicle Weight)*	4,340	5,188	5,340	3,850	4,173	5,770	6,770	6,880	7,260
Dry Hitch Weight*	230	308	345	410	520	820	900	1,120	1,330
Dry Axle Weight*	4,110	4,880	4,995	3,440	3,653	4,950	5,870	5,760	5,930
NCC (Net Carrying Capacity)	2,660	2,752	2,735	2,650	2,827	3,030	2,030	3,120	2,740
GVWR	7,000	7,940	7,940	6,500	7,000	8,800	8,800	10,000	10,000
Interior Height	78"	78"	78"	78"	78"	78"	96"	78"	96"
Exterior Height w/ A/C	10' 8"	10' 7"	10' 8"	10' 5 1/2"	10' 5 1/2"	10' 5 1/2"	12' 3"	10' 8"	11' 9"
Exterior Width	96"	96"	96"	96"	96"	96"	96"	96"	96"
Exterior Length	29' 3"	32' 10"	32' 9"	22' 10"	24' 5 1/2"	34'	33' 11"	35' 7"	35' 4"
Refrigerator (cu. feet)	6	6	6	6	6	6	6	6	6
Water Heater Cap. (gal. G/E w/DSI)	6	6	6	6	6	6	6	6	6
Fresh Water Cap. (gal.)	50	58	58	58	58	95	100	95	100
Waste Water Cap. (gal.)	32	32	32	32	32	32	32	32	32
Gray Water Cap. (gal.)	32	32	32	32	32	32	32	32	32
LP Gas Cap. (lbs.)	40	40	40	40	40	40	40	40	40
Furnace BTUs (1,000s)	16	20	20	20	20	25	25	25	25
Tire Size	15"	15"	15"	14"	14"	15"	15"	15"	15"
Awning	10'	15'	14'	13'	16'	20'	20'	20'	20'
Platform Size	8' x 8'	8' x 8'	8' x 8'	N/A	N/A	N/A	N/A	N/A	N/A

\*This weight reflects the rolling average unit weight for each model. Your trailer weight will vary according to optional equipment.



Nutmeg Décor

Zorro Décor

Cognac Maple

Smart Cherry

### Standards

- 1 Piece Seamless Roof with SuperFlex Roofing Material
- 3 Burner Range with Oven
- 4 Stabilizer Jacks
- 6 Cubic Foot Refrigerator
- 6 Gallons Gas/Electric DSI Water Heater
- 12V Range Hood with Light
- 20# LP Bottles
- 30 AMP Power Cord
- 13,500 BTU A/C
- AL-KO Ultra-Lube Axles
- AM/FM/CD Player
- Auto Adjust Brakes
- Awning with Drip Rail and Spouts
- Bottle Cover with Flip Up Lid
- Cargo D-Rings
- Decorative Radius Detail on Ceiling with Halogen Lights
- Double Bowl Sink with High Rise Faucet
- Extra Large Water Tanks
- Fiberglass Exterior
- Heated and Enclosed Underbelly (MXT303, MXT309, MXT312 and MXT319 Only)
- Innerspring Mattress (Where Available)
- Large Assist Grab Handle
- Lighted Power Awning (MXT303, MXT309, MXT312 and MXT319 Only)
- Microwave
- Mortise and Tenon Glazed Cabinet Doors
- Nightshades

- Outside Spray Port
- Radius Entry Door
- Ramp Door Light
- Satellite Prep
- Tinted Windows
- Tub Surround
- Tuff Ply (MXT303, MXT309, MXT312 and MXT319)
- TV Antenna with Booster
- Water Heater Bypass

### Sport Entertainment Package #1

- Sony® 4-Channel Amp
- Sony® 6 1/2" Coax Speakers Outdoor
- Sony® 10" Subwoofer
- Sony® AM/FM/CD with USB Port
- Sony® Marine Remote
- Speaker Box
- Water Heater Bypass

### MXT Package

- Aluminum Wheels
- Pull Down Screen Wall
- Ramp Extension and Legs
- Spare Tire/Carrier/Hoist

### Options

- 4.0 Generator (Requires Fuel Tank with Pump) (N/A on MXT20 or with 50 Amp)
- 5.5 Generator (Requires 50 Amp Service)
- 19" TV (MXT20 Only)

- 29" TV (MXT160, MXT303 and MXT309 Only)
- 32" TV (MXT312 and MXT319 Only)
- Aluminum Wheels (MXT Package)
- Dual Power Beds (MXT309 and MXT319 Only)
- Flip Up Full Size Bed (N/A on MXT20 and MXT160)
- Fuel Tank with Pump Station
- Generator Prep (Requires Fuel Tank with Pump) (N/A on MXT20)
- Lighted Power Awning (MXT20, MXT160 and All CRC Models Only)
- Mudd Tires (Available on CRC Models Only)
- Outside Grill
- Outside Speakers (Included in Sport Package #1)
- Paint Package
- Power Bed (MXT303, MXT309, MXT312 and MXT319 Only) (N/A with Sit'n Sleep)
- Power Bed with Sit'n Sleep (MXT309 and MXT319 only)
- Power Front/Rear Jacks and Tongue Jack
- Radiant Technology Insulation
- Ramp Extension and Legs (MXT Package)
- Sit'n Sleep (MXT303, MXT309, MXT312 and MXT319 Only) (N/A with Power Bed)
- Spare Tire/Carrier (MXT Package)
- Sport Entertainment Package #1
- Theatre Seating (MXT312 and MXT319 Only)
- Threshold Ramp
- Versa-Trac (Where Available)
- Wire for 2nd A/C with 50 Amp Service



**Dealer Satisfaction Index:**  
Ratings of manufacturers, by dealers, have consistently awarded KZ top honors for excellence of design, reliability, overall quality and value, communications and dealer support.



Dealer:



Join our Family Forum at  
[www.kzfamilyforum.com](http://www.kzfamilyforum.com)

**ASK ABOUT OUR 2-YEAR LIMITED WARRANTY!**

For more product details and in-depth information, visit us at [www.kz-rv.com](http://www.kz-rv.com)



0985 N 900 W • Shipshewana, IN 46565  
E-mail [kz@kz-rv.com](mailto:kz@kz-rv.com) • [www.kz-rv.com](http://www.kz-rv.com)



*Due to continual research and advances, manufacturer reserves the right to change specifications, design, price and equipment without notice, and assumes no responsibility for any error in this literature. Some items shown are not included as standard or optional equipment. ©2013KZ | 10/31/13 | 20M*