

# Sportsmen

## CV

classie



Ultra Lightweight Travel Trailers



Good things come in small packages, like the Sportsmen Classic, engineered for today's smaller tow vehicles. The **190** provides all the essentials you will need including kitchenette, closet, dinette and overhead cabinetry. Additionally, choose from our list of popular options to personalize yours.

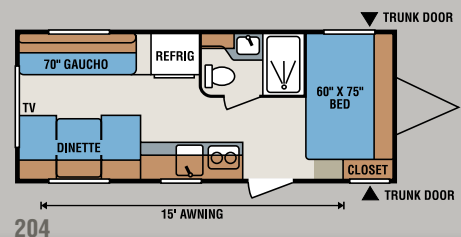
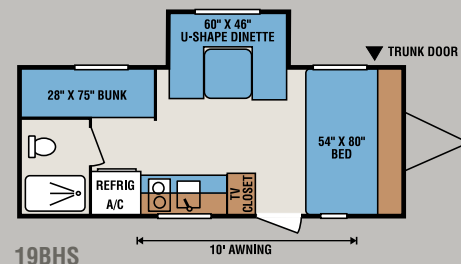
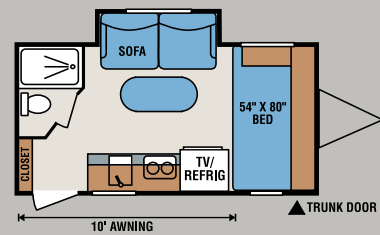
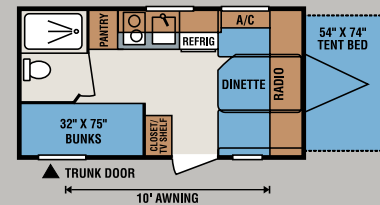
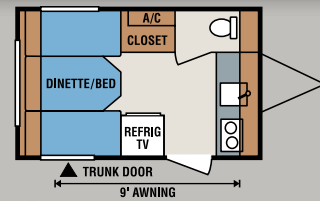

### Travel Trailers

UVW (Unloaded Vehicle Weight)\*

Dry Hitch Weight\*

Dry Axle Weight\*

NCC (Net Carrying Capacity)

GVWR

Interior Height

Exterior Height w/ A/C

Exterior Width

Exterior Length

Refrigerator (cu. feet)

Water Heater Cap. (gal. G/E w/DSI)

Fresh Water Cap. (gal.)

Waste Water Cap. (gal.)

Gray Water Cap. (gal.)

LP Gas Cap. (lbs.)

Furnace BTUs (1,000s)

Tire Size

Awning

\*This weight reflects the rolling average unit weight for each model. You

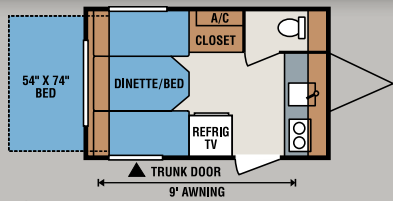

13FKT

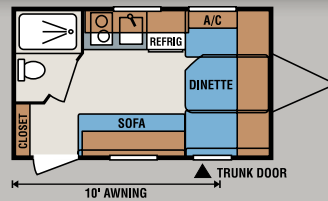

14RB

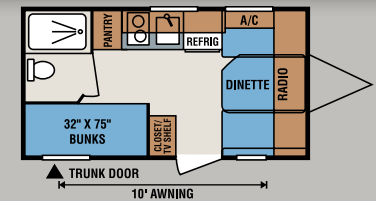

16BH

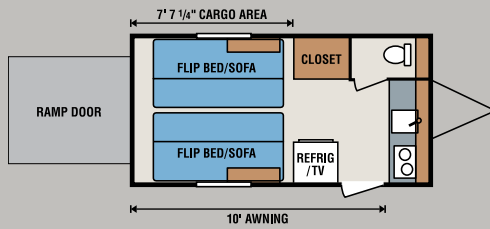

16FKTH

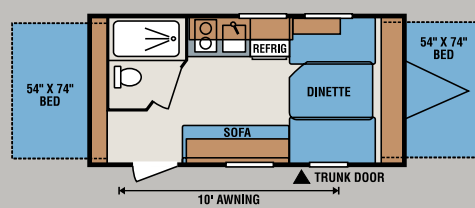

16RBT

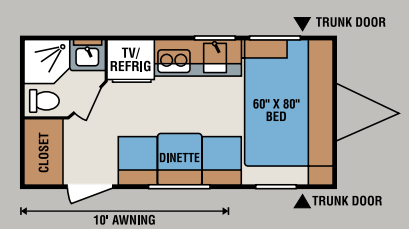

170

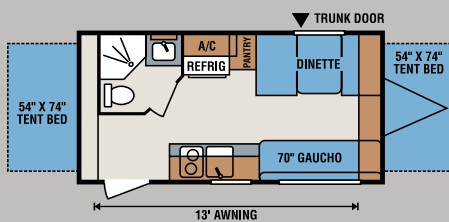

18RBT

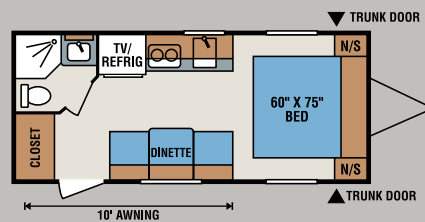

190

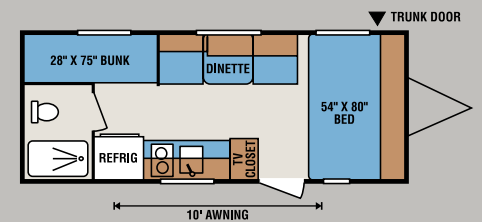

19BH

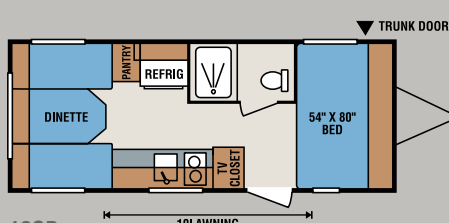

19SB

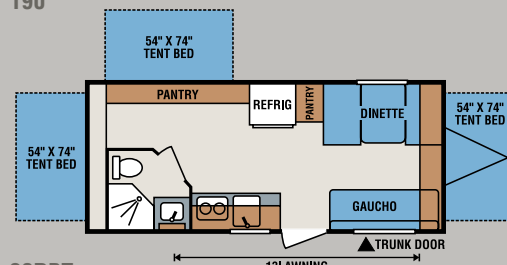

20RBT

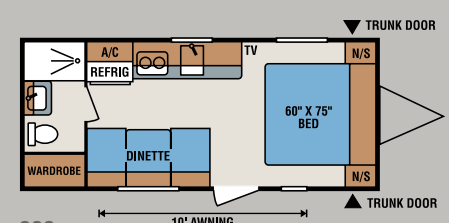

200

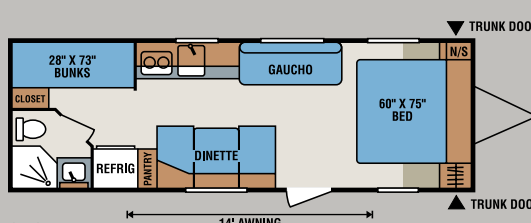

240

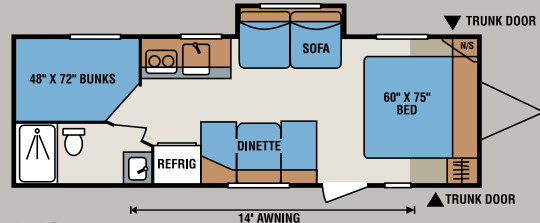

250S

13FK	13FKT	14RB	16BH	16BHT	16FKTH	16RBT	170	17RBS	18RBT	190	19BH	19BHS	19SB	20RBT	200	204	240	250S
1,993	2,023	2,126	2,263	2,350	2,283	2,383	2,623	2,530	2,696	2,740	2,623	2,840	2,633	3,116	2,713	3,163	3,446	3,690
273	230	323	343	380	390	343	366	420	336	376	346	370	356	426	336	453	363	510
1,720	1,793	1,803	1,920	1,970	1,893	2,040	2,257	2,110	2,360	2,364	2,277	2,470	2,277	2,690	2,377	2,710	3,083	3,180
807	777	674	537	450	1,217	417	877	970	804	760	877	660	867	1,384	787	1,337	1,354	1,110
2,800	2,800	2,800	2,800	2,800	3,500	2,800	3,500	3,500	3,500	3,500	3,500	3,500	3,500	4,500	3,500	4,500	4,800	4,800
75"	75"	75"	75"	75"	75"	75"	75"	75"	75"	75"	75"	75"	75"	75"	75"	75"	75"	75"
99"	99"	101.5"	101.5"	101.5"	102"	98"	103"	8' 11"	111"	103"	100"	107"	100"	115"	103"	117"	117"	107"
84"	84"	84"	84"	84"	84"	84"	90"	84"	90"	90"	84"	84"	84"	90"	90"	90"	90"	90"
13' 9"	13' 9"	15' 10"	17' 2"	17' 2"	17'	17' 2"	19' 9"	17' 11"	18' 10"	22' 1"	20' 6"	20' 6"	20' 6"	21'	22'	23'	26' 11"	27' 3"
3	3	3	3	3	3	3	4.6	4.6	4.6	4.6	4.6	4.6	4.6	5	4.6	5	5	5
6	6	6	6	6	6	6	6	6	6	6	6	6	6	6	6	6	6	6
10	10	10	10	20**	10	20**	20	20**	20	20	20	20	20	20	20	20	20	20
5	5	9	9	9	5	9	32	9	24	32	9	9	15	24	26	24	24	24
9	9	15	15	15	9	15	32	15	32	32	15	15	15	32	32	24	31	31
20	20	20	20	20	20	20	20	20	20	20	20	20	20	20	20	20	20	20
16	16	16	16	16	16	16	16	16	16	16	16	16	16	16	16	16	16	16
13"	13"	13"	13"	14"	14"	13"	14"	14"	14"	14"	14"	14"	14"	13"	14"	13"	13"	13"
9'	9'	10'	10'	10'	10'	10'	10'	10'	13'	10'	10'	10'	10'	13'	10'	15'	14'	14'

Trailer weight will vary according to optional equipment.

\*\*Effective on all models built after 3/1/14.





190

A large comfortable bed with nightstands offer a restful location at the end of a busy day.

190

### Standards

- 1 LP Tank
- 2 Burner Gas Hot Plate
- 2 Stabilizer Jacks
- 6 Gallon Gas DSI Water Heater
- 12 Volt Converter with Charger
- 13"/14" Tires
- 54" Dinette Seats
- Alum-A-Tough Roofing w/12 Year Limited Warranty
- Awning with Hardware
- Cable Hook Up

- City Water Fill
- Dexter **NEV-R-ADJUST**® Electric Brakes
- Diamond Plate on Front
- Gas/Electric Refrigerator
- Microwave
- Norco/BAL Huck Bolted Frame (E-Coated) and A-Frame (Epoxy Painted)
- Overhead Cabinets
- R-7 Insulation
- Radial Tires
- Rear Bumper with Sewer Hose Storage

- Shower and Toilet
- Single Bowl Sink
- Spare Tire
- Tinted Windows
- TV Antenna

### Options

- 2 Additional Stabilizer Jacks
- 6 Cubic Foot Refrigerator (20RBT, 200, 204, 240, and 250S)
- 6,000 BTU Air Conditioner (13s, 14s, 16BH, 16FKTH, 170, 17RBS and 18RBT Only)

- 8,000 BTU Air Conditioner (13s, 14s, 16BH, 16RBT, 16FKTH, 170, 170RBS, 18RBT, 19s, 190, and 200 Only)
- 13,500 BTU Air Conditioner (Roof Air) (19SB, 19BH, 190, 200, 204, 240, and 250S Only)
- 16,000 BTU Furnace
- AM/FM/MP3/iPod Radio
- Front Window (N/A on Tent Models, 13FK and 16FKTH)
- Surge Brakes
- U-Dinette IPO Front Bed (19BH Only)



**Dealer Satisfaction Index:**  
Ratings of manufacturers, by dealers, have consistently awarded KZ top honors for excellence of design, reliability, overall quality and value, communications and dealer support.



Portions of this brochure were used with the expressed authority of Dexter Axle, but Dexter Axle is not responsible for the accuracy of the information contained herein.



Dealer:



Join our Family Forum at [www.kzfamilyforum.com](http://www.kzfamilyforum.com)

**ASK ABOUT OUR 1-YEAR LIMITED WARRANTY!**

For more product details and in-depth information, visit us at [www.kz-rv.com](http://www.kz-rv.com)



0985 N 900 W • Shipshewana, IN 46565  
E-mail [kz@kz-rv.com](mailto:kz@kz-rv.com) • [www.kz-rv.com](http://www.kz-rv.com)



*Due to continual research and advances, manufacturer reserves the right to change specifications, design, price and equipment without notice, and assumes no responsibility for any error in this literature. Some items shown are not included as standard or optional equipment. ©2014KZ | 4/10/14 | 15M*