

Spree **ESCAPE**



Ultra Lightweight Travel Trailers



E196S
Fawn Décor

Engineered for today's smaller tow vehicles, Spree Escape offers many standard essentials including AM/FM/MP3/iPod radio, tinted windows, A/C, stabilizer jacks, spare tire, awning and diamond plated rock guard. The E196S features overhead storage and closet near bunks in addition to kitchen cabinetry.



Travel Trailers

- UVW (Unloaded Vehicle Weight)*
- Dry Hitch Weight*
- Dry Axle Weight*
- NCC (Net Carrying Capacity)
- GVWR
- Interior Height
- Exterior Height w/ A/C
- Exterior Width
- Exterior Length
- Refrigerator (cu. feet)
- Water Heater Cap. (gal. G/E w/DSI)
- Fresh Water Cap. (gal.)
- Waste Water Cap. (gal.)
- Gray Water Cap. (gal.)
- LP Gas Cap. (lbs.)
- Furnace BTUs (1,000s)
- Tire Size
- Awning

*This weight reflects the rolling average

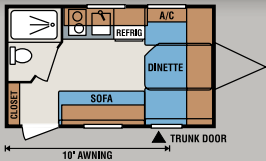

E14RB

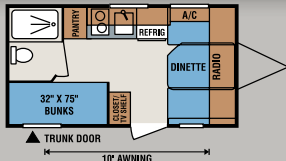

E16BH

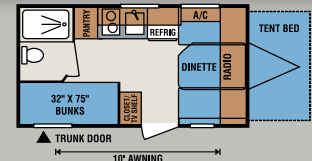

E16BHT

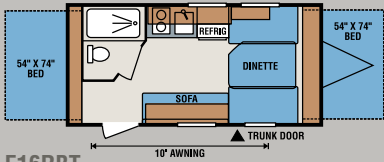

E16RBT

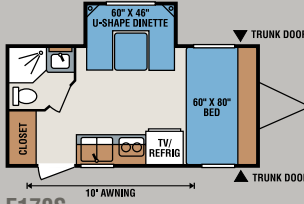

E170S

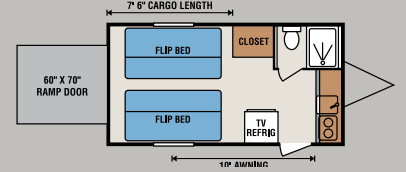

E17FKTH

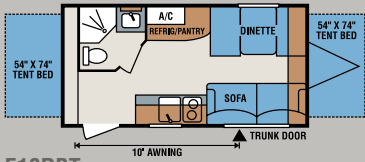

E18RBT

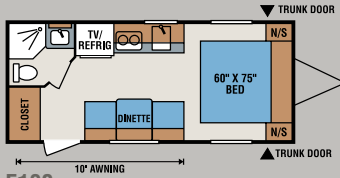

E190

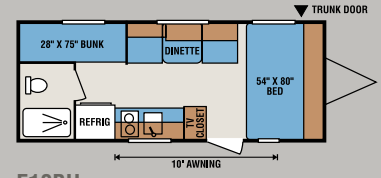

E19BH

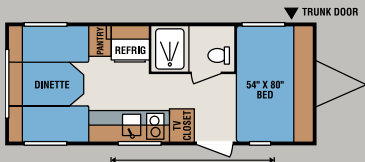

E19SB

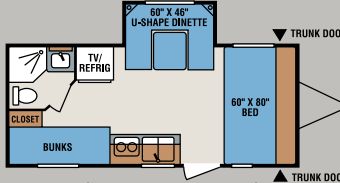

E196S

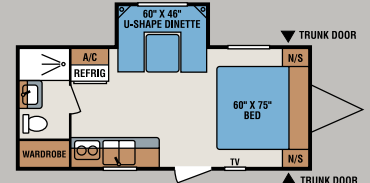

E200S

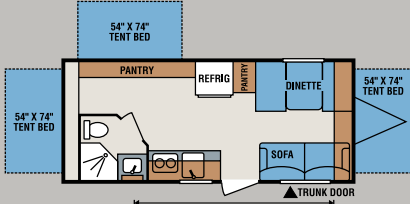

E20RBT

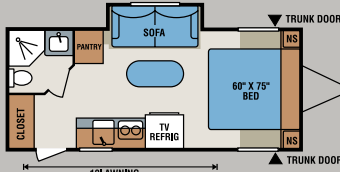

E202S

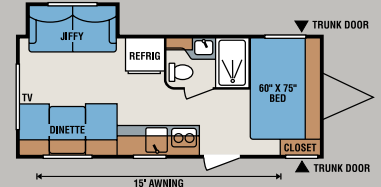

E204S

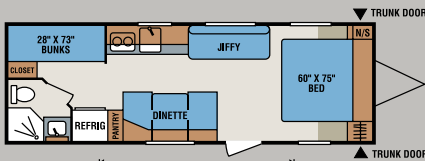

E240

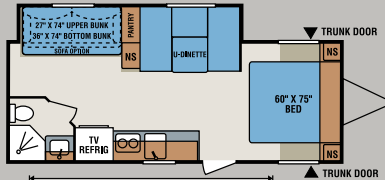

E243S

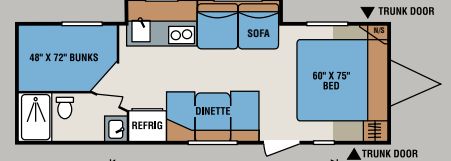

E250S

E14RB	E16BH	E16BHT	E16RBT	E170S	E17FKTH	E18RBT	E190	E19BH	E19SB	E196S	E200S	E20RBT	E202S	E204S	E240	E243S	E250S
2,202	2,356	2,430	2,398	2,735	2,380	2,690	2,860	2,694	2,698	2,915	2,960	3,220	3,050	3,320	3,630	3,630	3,760
287	258	330	293	385	390	350	420	325	333	340	250	420	340	410	430	380	540
1,915	2,098	2,100	2,105	2,350	1,990	2,340	2,440	2,369	2,365	2,575	2,710	2,800	2,710	2,910	3,200	3,250	3,220
598	444	570	402	765	1,120	810	640	806	802	585	540	1,280	1,450	1,180	870	870	740
2,800	2,800	3,000	2,800	3,500	3,500	3,500	3,500	3,500	3,500	3,500	3,500	4,500	4,500	4,500	4,500	4,500	4,500
75"	75"	75"	75"	75"	75"	75"	75"	75"	75"	75"	75"	75"	75"	75"	75"	75"	75"
99"	99"	99"	99"	101"	102"	102"	103"	100"	100"	101"	101"	102"	102"	107"	108"	103"	107"
84"	84"	84"	84"	90"	90"	90"	90"	84"	84"	90"	90"	90"	90"	90"	90"	90"	90"
16'	17' 4"	17' 4"	17' 4"	19' 9 1/2"	17' 4"	19' 1"	22' 1"	20' 9"	20' 9"	22' 1 1/2"	22' 1/2"	21'	22' 6"	23' 4 1/2"	26' 11"	24' 10"	27' 3"
3	3	3	3	4	3	4	4	4	4	4	4	5	4	5	5	5	5
6	6	6	6	6	6	6	6	6	6	6	6	6	6	6	6	6	6
10	10	10	10	20	10	20	20	20	20	20	20	20	20	20	20	20	20
9	9	9	9	32	5	24	32	9	15	32	26	24	24	24	24	24	24
15	15	15	15	32	26	32	32	15	15	32	32	24	31	24	31	31	31
20	20	20	20	20	20	20	20	20	20	20	20	20	20	20	20	20	20
16	16	16	16	16	16	16	16	16	16	16	16	16	16	16	16	16	16
13"	13"	13"	13"	14"	14"	14"	14"	14"	14"	14"	14"	13"	13"	13"	13"	13"	13"
10'	10'	10'	10'	10'	10'	10'	10'	10'	10'	10'	10'	13'	12'	15'	14'	15'	14'

unit weight for each model. Your trailer weight will vary according to optional equipment.



E18RBT
Fawn Décor

Double tent ends along with dinette and sofa provide sleep space for family and friends.



E18RBT Fawn Décor



Fawn Décor

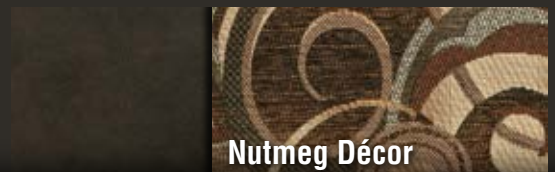

Nutmeg Décor

Standards

- 2 Burner Cooktop
- 2 Stabilizer Jacks
- 3 Cubic Foot Gas/Electric Refrigerator (E14RB, E16BH, E16RBT and E17FKTH Only)
- 4 Cubic Foot Gas/Electric Refrigerator (E170S, E18RBT, 19s, E200S and E202S Only)
- 5 Cubic Foot Refrigerator (E20RBT, E204S, E243S and E250S Only)
- 6 Gallon Gas DSI Water Heater
- 12V Converter with Charger
- 20# Gas Bottle
- 54" Dinette Seats
- Alum-A-Tough Roofing w/12 Year Limited Warranty

- AM/FM/MP3/iPod Radio
- Awning
- Bedspread
- Border Tape
- Cable Hook Up
- City Water Fill
- Dexter **NEV-R-ADJUST**® Electric Brakes
- Diamond Plate Rock Guard
- Headboard
- Innerspring Mattress
- Microwave
- Norco/BAL Huck Bolted Frame (E-Coated) and A-Frame (Epoxy Painted)
- Overhead Cabinets

- R-7 Insulation
- Radial Tires
- Rear Bumper with Sewer Hose Storage
- Shower and Toilet
- Spare Tire and Carrier
- TV Antenna
- Tinted Windows

- 8,000 BTU Air Conditioner (E16s, E170S, E18RBT, E19s, E190S, E196S and E200S Only)
- 13,500 BTU Air Conditioner (E19BH, E19SB, E190S, E196S, E200S, E202S, E204S, E240S, E243S and E250S Only)
- 16,000 BTU Furnace
- Aluminum Wheels (2 or 4)
- Front Windows (N/A on E16RBT, E17FKTH, E18RBT and E20RBT)
- Lighted Power Awning
- Surge Brakes
- U-Shape Dinette IPO Front Bed (E19BH Only)

Options

- 2 Additional Stabilizer Jacks
- 6 Cubic Foot Refrigerator (E20RBT, E200S, E204S, E240, E243S and E250S Only)
- 6,000 BTU Air Conditioner (E14s, E16s, and E170S Only)



Dealer Satisfaction Index:
Ratings of manufacturers, by dealers, have consistently awarded KZ top honors for excellence of design, reliability, overall quality and value, communications and dealer support.



Portions of this brochure were used with the expressed authority of Dexter Axle, but Dexter Axle is not responsible for the accuracy of the information contained herein.



Dealer:



Join our Family Forum at
www.kzfamilyforum.com

ASK ABOUT OUR 1-YEAR LIMITED WARRANTY!

For more product details and in-depth information, visit us at www.kz-rv.com



0985 N 900 W • Shipshewana, IN 46565
E-mail kz@kz-rv.com • www.kz-rv.com



Due to continual research and advances, manufacturer reserves the right to change specifications, design, price and equipment without notice, and assumes no responsibility for any error in this literature. Some items shown are not included as standard or optional equipment. ©2014KZ | 4/7/14 | 15M