

Sportsmen

CV

classie



Ultra Lightweight Travel Trailers



190

The Sportsmen Classic provides all the basics in a light weight package that can be towed by minivans and small SUVs. Sportsmen Classic is a versatile product that highlights the following floor plans with and without slide-outs, hybrid tent ends and even a small toy hauler.



190 Large overhead provides extra storage.



**New
Aerodynamic
Profile**

Travel Trailers

UVW (Unloaded Vehicle Weight)*

Dry Hitch Weight*

Dry Axle Weight*

NCC (Net Carrying Capacity)

GVWR

Interior Height

Exterior Height w/o A/C

Exterior Width

Exterior Length

Refrigerator (cu. feet)

Water Heater Cap. (gal. G/E w/DSI) *OPTIONAL*

Fresh Water Cap. (gal.)

Waste Water Cap. (gal.)

Gray Water Cap. (gal.)

LP Gas Cap. (lbs.) *OPTIONAL*

Furnace BTUs (1,000s) *OPTIONAL*

Tire Size

Awning *OPTIONAL*

*This weight reflects the rolling average unit weight

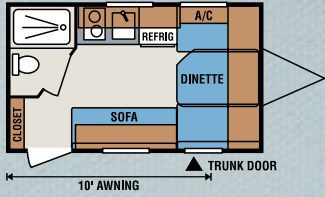

14RB

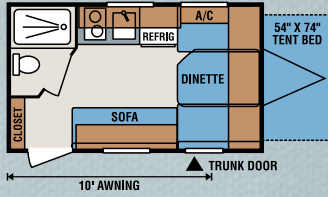

14RBT

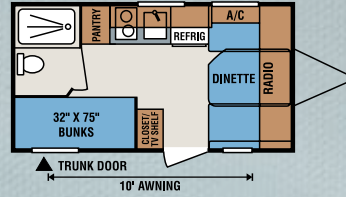

16BH

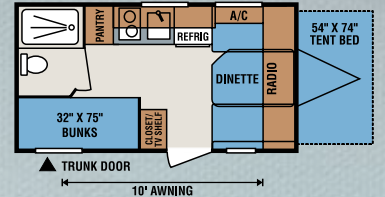

16BHT

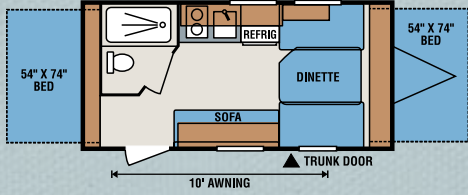

16RBT

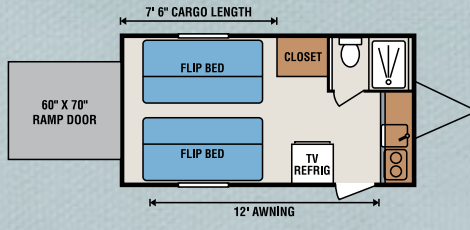

17FKTH

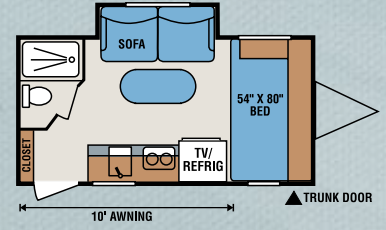

17RBS

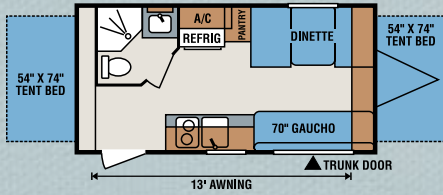

18RBT

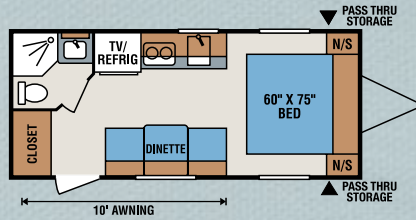

190

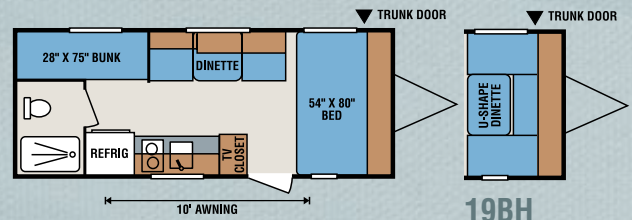

19BH

19BH
U-Shape
Dinette Option

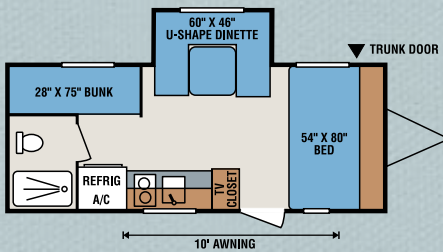

19BHS

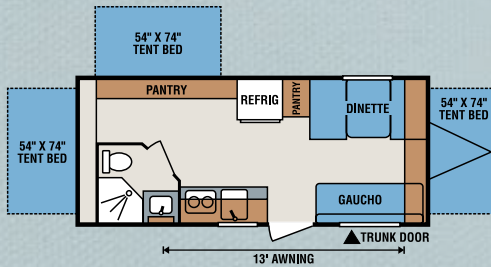

20RBT

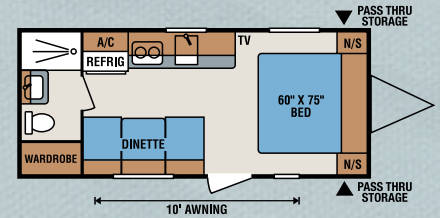

200

14RB	14RBT	16BH	16BHT	16RBT	17FKTH	17RBS	18RBT	190	19BH	19BHS	20RBT	200
2,126	2,170	2,263	2,350	2,383	2,400	2,530	2,696	2,740	2,623	2,840	3,116	2,713
323	400	343	380	343	350	420	336	376	346	370	426	336
1,803	1,770	1,920	1,970	2,040	2,050	2,110	2,360	2,364	2,277	2,470	2,690	2,377
674	630	537	450	417	1,100	970	804	760	877	660	1,384	787
2,800	2,800	2,800	2,800	2,800	3,500	3,500	3,500	3,500	3,500	3,500	4,500	3,500
75"	75"	75"	75"	75"	75"	75"	75"	75"	75"	75"	75"	75"
101.5"	101.5"	101.5"	101.5"	98"	102"	107"	111"	103"	100"	107"	115"	103"
84"	84"	84"	84"	84"	90"	84"	90"	90"	84"	84"	90"	90"
15' 10"	15' 10"	17' 2"	17' 2"	17' 2"	17' 4"	17' 11"	18' 10"	22' 1"	20' 6"	20' 6"	21'	22'
3	3	3	3	3	3	4.6	4.6	4.6	4.6	4.6	5	4.6
6	6	6	6	6	6	6	6	6	6	6	6	6
20	20	20	20**	20**	38	20**	20	20	20	20	20	20
9	9	9	9	9	5	9	24	32	9	9	24	26
15	15	15	15	15	26	15	32	32	15	15	32	32
20	20	20	20	20	20	20	20	20	20	20	20	20
16	16	16	16	16	16	16	16	16	16	16	16	16
13"	13"	13"	14"	13"	14"	14"	14"	14"	14"	14"	13"	14"
10'	10'	10'	10'	10'	12'	10'	13'	10'	10'	10'	13'	10'

t for each model. Your trailer weight will vary according to optional equipment.



19BHS

The optional front window in the 19BHS provides additional light to the Classic living area.



19BHS

19BHS
Dinette table quickly converts into more sleeping area.



Standards

- 1 LP Tank
- 2 Burner Gas Hot Plate
- 2 Stabilizer Jacks
- 6 Gallon Gas DSI Water Heater
- 12 Volt Converter with Charger
- 13"/14" Tires
- 5" Thick Dinette Seats
- Alum-A-Tough Roofing with 12 Year Limited Warranty
- Awning with Hardware
- Cable Hook Up
- City Water Fill
- Diamond Plate on Front
- Gas/Electric Refrigerator
- Microwave
- Norco/Bal Frame (E-Coated) and A-Frame (Epoxy Painted)
- Overhead Cabinets
- R-7 Insulation
- Radial Tires
- Rear Bumper with Sewer Hose Storage
- Self-Adjust Electric Brakes
- Shower and Toilet
- Single Bowl Sink
- Spare Tire
- Tank Monitor Panel
- Tinted Windows
- TV Antenna

Options

- 2 Additional Stabilizer Jacks
- 6 Cubic Foot Refrigerator (Floorplan Specific)
- 8,000 BTU Air Conditioner
- 13,500 BTU Air Conditioner (Roof Air)
- 16,000 BTU Furnace
- AM/FM/MP3/iPod Radio
- Front Window (N/A on Tent Models and 17FKTH)
- Surge Brakes
- U-Dinette IPO Front Bed



Dealer Satisfaction Index: Ratings of manufacturers, by dealers, have consistently awarded KZ top honors for excellence of design, reliability, overall quality and value, communications and dealer support.



Dealer:

ASK ABOUT OUR 1-YEAR LIMITED WARRANTY!



Join our Family Forum at www.kzfamilyforum.com

For more product details and in-depth information, visit us at www.kz-rv.com



985 N 900 W • Shipshewana, IN 46565
E-mail kz@kz-rv.com • www.kz-rv.com



Due to continual research and advances, manufacturer reserves the right to change specifications, design, price and equipment without notice, and assumes no responsibility for any error in this literature. Some items shown are not included as standard or optional equipment. ©2015KZ | 1/22/15 | 20M