

CONNECT

Spree[®]



Lightweight Travel Trailers



Connect with the outdoors in this well-appointed lightweight trailer. Spree Connect has been designed for midsize SUVs and ½ ton trucks. With both travel trailers and hybrids that feature tent ends, these versatile trailers are built for the most discerning buyer.

C232IKS
Ginger Décor with
Woodbridge Maple



C232IKS Kitchen island provides extra prep area and storage below the countertop on each end.



C232IKS The bathroom has a mirrored medicine cabinet and radius glass shower doors.



C232IKS Designer headboard with overhead storage.



Cotton Cloud deep quilted mattress.



C250BHS
Ginger Décor with
Woodbridge Maple

The Spree Connect 250BHS has a large U-shaped dinette that easily converts into a 74" sleeping area.

The standard skylight provides natural light in the Connect.



The Connect bathroom features a multi-shelved shower surround with designer shower curtain.



Far right photo: The 250BHS features double over double bunk beds with Teddy Bear mattresses.



C250BHS The Connect's stereo system is a Jensen Bluetooth with AM/FM/DVD/CD/MP3 player shown with optional 39" LED TV.



C250BHS Full queen bed with designer padded headboard.

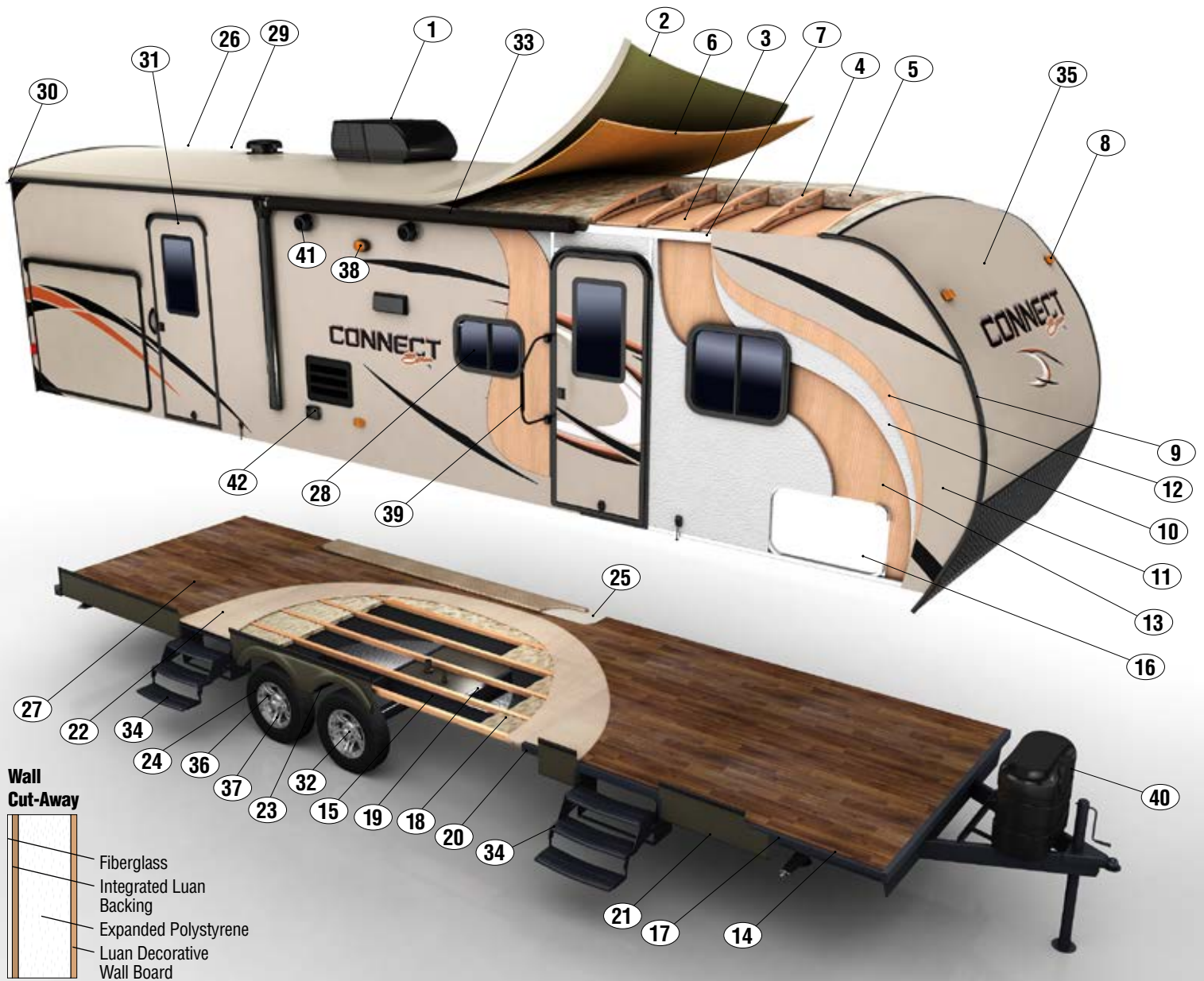

- | | | |
|--|---|---|
| 1 13,500 BTU A/C | 15 Darco® Corrugated Moisture Barrier | 29 Triple Sealed Slide Outs |
| 2 SuperFlex Seamless 1-Piece Roofing Material | 16 Extra-Large Radius Baggage Doors | 30 Extra Long Drip Spouts |
| 3 Vinyl Interior Ceiling Panel | 17 Heavy Duty I-beam Frame Construction | 31 Radius Entrance Door with Window |
| 4 4 1/2" Arched Truss Rafters, 16" O.C. | 18 R-7 Batten Insulation | 32 EZ Lube Axles |
| 5 R-7 Batten Insulation | 19 2" x 3" Wood Floor Joists, 16" O.C. | 33 Multi-directional LED Lighted Power Awning (Option) |
| 6 3/8" Walkable Roof Decking | 20 Heated & Enclosed Underbelly | 34 Triple Steps |
| 7 Heavy Duty Aluminum Headers | 21 Fully Welded Outriggers | 35 Aerodynamic Fiberglass Front |
| 8 Exterior Clearance and Brake Lights | 22 5/8" Tongue and Groove Plywood Decking | 36 Auto Adjusting Brakes |
| 9 Aerodynamic Front Profile | 23 Heavy Duty Leaf Springs | 37 Aluminum Rim (Option) |
| 10 Expanded Polystyrene R-7 | 24 15" Radial Tires | 38 Porch Light |
| 11 High Gloss Champagne Color Infused Exterior Fiberglass | 25 Residential Style Carpet Pad | 39 Large Assist Grab Handle |
| 12 1/8" Luan | 26 Rack and Pinion Electric Slide with Manual Override with Box Tube Slide Out Ram | 40 (2) 20# LP Tanks with Flip-Up Access Lid |
| 13 1/8" Luan Decorative Wall Board | 27 Residential Carpet or Linoleum | 41 2 Marine Grade Exterior Speakers |
| 14 3" Stringer | 28 Tinted Safety Glass Windows | 42 110 Outlet |

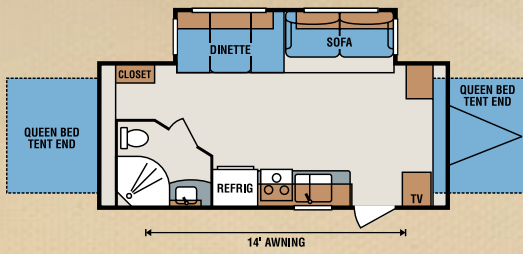

C200RBT

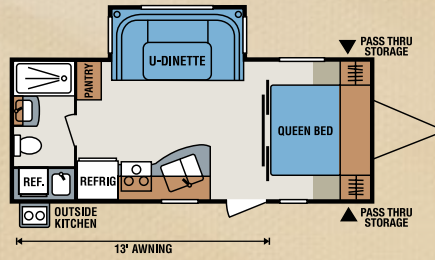

C220RBK

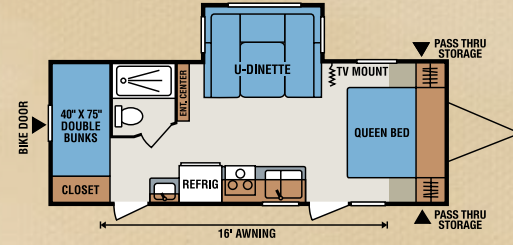

C231BHS

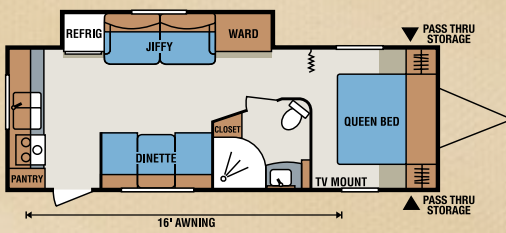

C260RKS

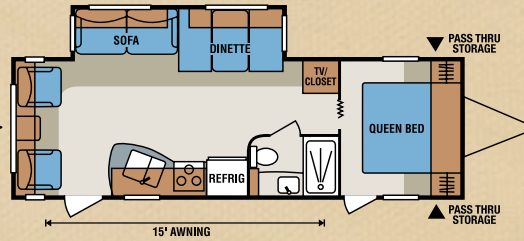

C280RLS

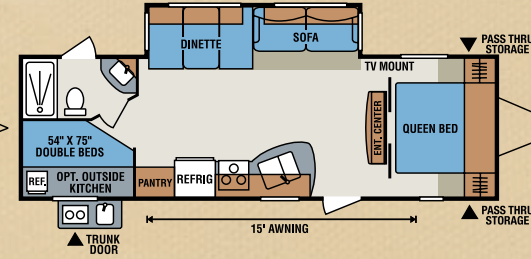

C283BHS

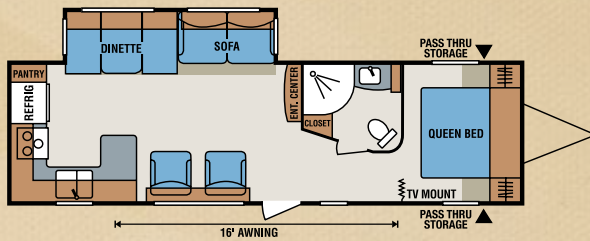

C310RKS

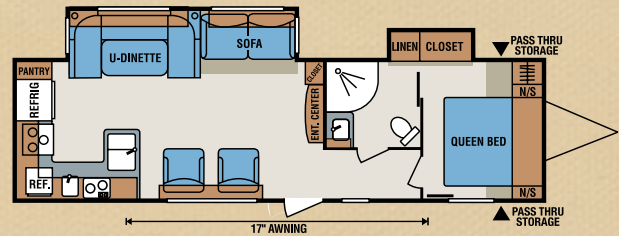

C321RKS

Lightweight Travel Trailers

	C200RBT	C220RBK	C231BHS	C232IKS	C241RKS	C250BHS
UVW (Unloaded Vehicle Weight)*	4,790	4,700	4,790	5,440	4,490	5,120
Dry Hitch Weight*	670	490	540	670	510	690
Dry Axle Weight*	4,120	4,210	4,250	4,770	3,980	4,430
NCC (Net Carrying Capacity)	1,210	1,300	1,210	1,060	1,510	1,680
GVWR	6,000	6,000	6,000	6,500	6,000	6,800
Interior Height	78"	78"	78"	78"	78"	78"
Exterior Height w/ A/C	10' 8"	10' 7"	10' 4"	11' 2"	10' 3"	10' 7"
Exterior Width	96"	96"	96"	96"	96"	96"
Exterior Length	23' 7"	24' 9"	27'	25' 8"	25' 9"	28' 2"
Refrigerator (cu. feet)	6	6	6	6	6	6
Water Heater Cap. (gal. G/E w/DSI)	6	6	6	6	6	6
Fresh Water Cap. (gal.)	40	40	40	40	40	40
Waste Water Cap. (gal.)	32	32	32	32	32	32
Gray Water Cap. (gal.)	32	32	32	32	32	32
LP Gas Cap. (lbs.)	40	40	40	40	40	40
Furnace BTUs (1,000s)	20	20	20	20	20	20
Tire Size	14"	14"	14"	14"	14"	14"
Awning	14'	13'	16'	17'	14'	14'

*This weight reflects the rolling average unit weight for each model. Your trailer weight will vary according to optional equipment.

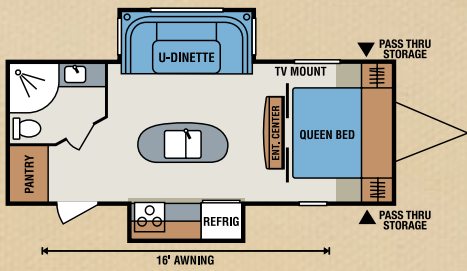

C232IKS

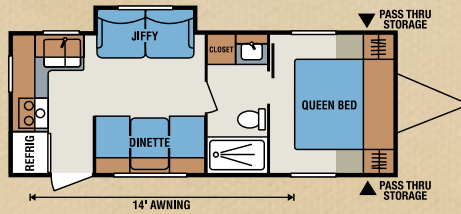

C241RKS

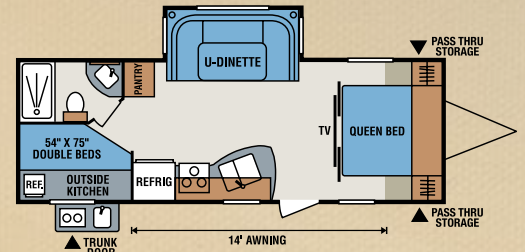

C250BHS

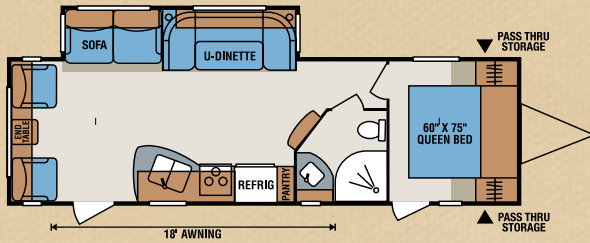

C290RLS

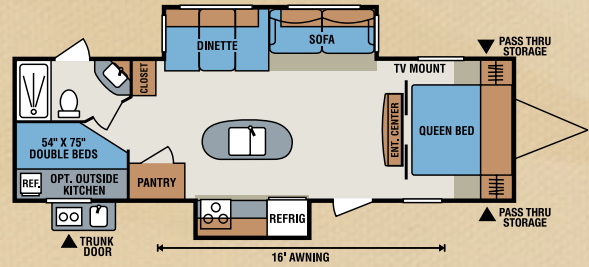

C291IKS

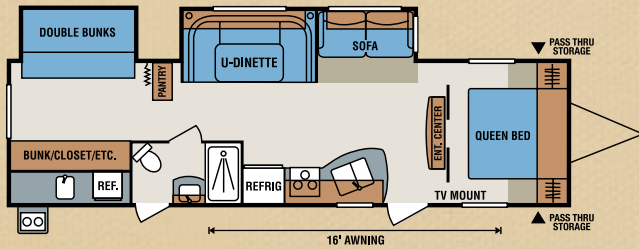

C322BHS

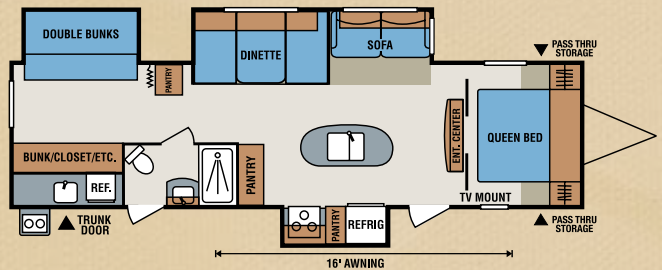

C322IKS

C260RKS	C280RLS	C283BHS	C290RLS	C291IKS	C310RKS	C321RKS	C322BHS	C322IKS
5,180	5,530	5,680	6150	6,540	6,150	6,770	6,910	7,450
490	680	750	660	800	490	700	730	850
4,690	4,850	4,930	5490	5,740	5,660	6,070	6,180	6,600
1,620	1,270	1,120	1850	1,460	2,150	1,530	1,390	1,350
6,800	6,800	6,800	8000	8,000	8,300	8,300	8,300	8,800
78"	78"	78"	78"	78"	78"	78"	78"	78"
10' 8 1/2"	10' 8 1/2"	10' 9"	11' 1"	11' 1"	11' 2"	11' 2"	10' 11"	11' 3"
96"	96"	96"	96"	96"	96"	96"	96"	96"
28' 8"	30' 1"	31' 4"	32' 6"	32' 6"	33' 5"	34' 6"	35' 6"	35' 6"
6	6	6	6	6	6	6	6	6
6	6	6	6	6	6	6	6	6
40	40	40	40	40	40	40	40	40
32	32	32	32	32	32	32	32	32
64	32	32	32	32	64	32	32	32
40	40	40	40	40	40	40	40	40
20	25	25	25	30	30	30	30	30
14"	14"	14"	15"	15"	15"	15"	15"	15"
16'	15'	15'	18'	16'	16'	17'	16'	16'

Ginger Décor

Woodbridge Maple



The optional slide out kitchen provides a sink, cook top and refrigerator to the exterior of the Spree Connect. (Varies by floorplan.)

Standards

- 3/8" Fully Walk On Roof with SuperFlex Roofing Material
- 5/8" Tongue and Groove Plywood Floor
- 2 Pillows for Sofa
- 4 Stabilizer Jacks
- 6 Cubic Double Door Refrigerator
- 6 Gallon Gas/Electric DSI Water Heater
- 20# Gas Bottles
- 30 Amp Service
- 13,500 BTU A/C
- Black Tank Flush
- Bottle Cover
- Decorative Wall Border
- Deep Quilt Cotton Cloud Mattress
- Designer Headboard
- Designer Quilted Bedspread
- Extra Large Baggage Doors
- EZ Lube Axles
- Fold Away Assist Grab Handle
- Gas Struts on Bed Base
- Hand Crafted Mortise and Tenon Glazed Cabinet Doors
- Heated and Enclosed Underbelly
- High Definition Designer Countertops
- High Rise Faucet
- Jensen AM/FM/CD/DVD player with Bluetooth
- Marine Grade Exterior Speakers
- Night Shades

- Outside Shower
- Oven
- Overhead Cabinets in Slide Over Sofa and Dinette
- Patio Light
- Protective Diamond Plate on Front End
- Rich Woodbridge Maple Cabinetry
- Roller Ball Bearing Drawer Glides
- Roof Vent in Bath
- Sandlewood Exterior
- Satellite and Cable Preparation
- Skylight in Kitchen
- Skylight Over Tub
- Teddy Bear Bunk Mats
- Tub Surround
- Water Heater By-Pass
- Wood Plank Look Flooring From Front to Rear

Options

- 15,000 BTU A/C
- Aluminum Wheels
- Deluxe Sleeper Sofa
- Multi-Directional LED Lighted Power Awning (Forced Option)
- Outside Refrigerator in Front Storage Compartment (Floorplan Dependant)
- Power Tongue Jack
- Spare Tire/Carrier/Cover
- Table and 4 Chairs
- TV



Above all slide-outs there are gutters to deflect water away from the double bulb seals.



Optional lighted power tongue jack with leveling bubble.



Extra large baggage door provides access to larger items. (Also houses opt. refrigerator.)



Black diamond plate offers durability and functionality to the front of the Connect.



Dealer Satisfaction Index: Ratings of manufacturers, by dealers, have consistently awarded KZ top honors for excellence of design, reliability, overall quality and value, communications and dealer support.



Dealer:

ASK ABOUT OUR 2-YEAR LIMITED WARRANTY!



Join our Family Forum at www.kzfamilyforum.com

For more product details and in-depth information, visit us at www.kz-rv.com



985 N 900 W • Shipshewana, IN 46565
E-mail kz@kz-rv.com • www.kz-rv.com



Due to continual research and advances, manufacturer reserves the right to change specifications, design, price and equipment without notice, and assumes no responsibility for any error in this literature. Some items shown are not included as standard or optional equipment. ©2015KZ | 1/22/15 | 20M