

# Vision<sup>®</sup>

ULTRA LIGHTWEIGHT TRAVEL TRAILERS





# Vision<sup>®</sup>

ULTRA LIGHTWEIGHT TRAVEL TRAILERS



## V23RLS

**Vision is a stylish ultra-lightweight travel trailer designed with your family's comfort in mind. Smart window placement, LED lighting throughout, as well as kitchen and bath skylights, provide ample illumination.**

Baths include a full-size shower, sink, foot-flush toilet and roomy privacy. Bedrooms offer a queen bed with reversible down comforter, under-bed storage and plenty of closet space.

Living room includes DVD/CD stereo w/Bluetooth and USB port and comfortable dining space. In the kitchen, you'll find stainless steel appliances and plenty of storage. Cabinets boast solid wood mortise and tenon doors. Deep double-bowl sinks make food prep and cleanup a breeze, and sink covers extend the counter space.



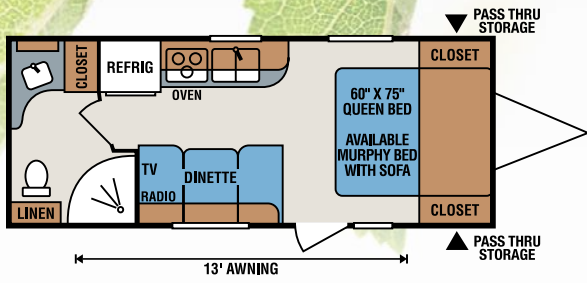

V19RB

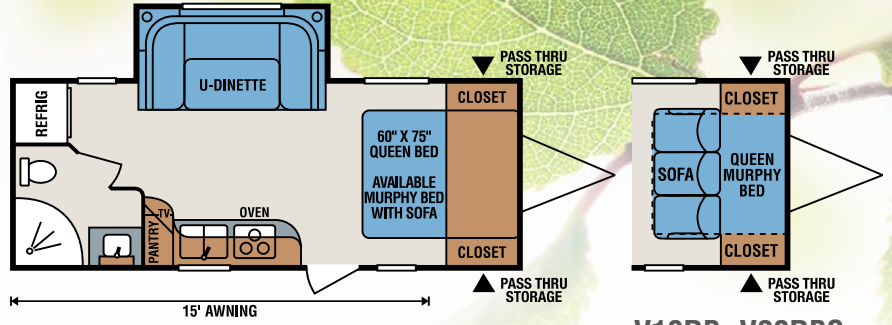

V20RBS

V19RB, V20RBS & V22BHS  
Murphy Bed Option

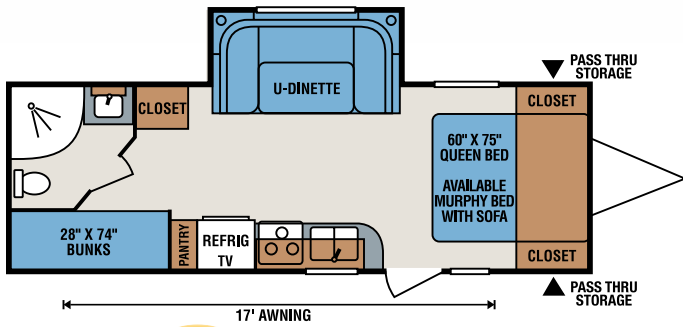

V22BHS **NEW**

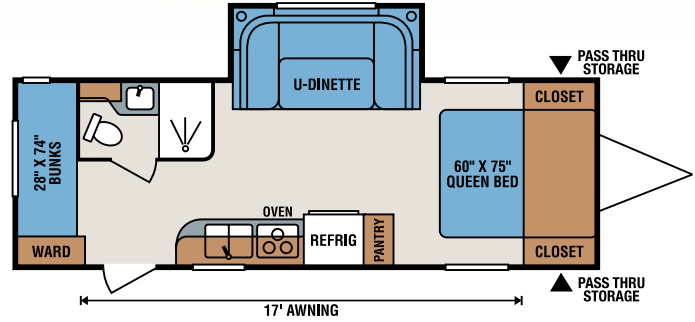

V23BHS

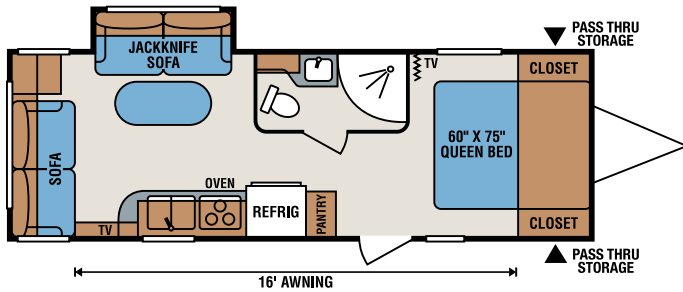

V23RLS



2016 Décor

Cityscape

Travel Trailers	V19RB	V20RBS	V22BHS	V23BHS	V23RLS
UVW (Unloaded Vehicle Weight)*	3,650	4,010	4,530	4,450	4,440
Dry Hitch Weight*	350	350	560	520	470
Dry Axle Weight*	3,300	3,660	3,970	3,930	3,970
NCC (Net Carrying Capacity)	1,550	1,190	1,070	1,150	1,060
GVWR	5,200	5,200	5,600	5,600	5,600
Interior Height	78"	78"	78"	78"	78"
Exterior Height w/ A/C	119"	119"	119"	119"	119"
Exterior Width	90"	90"	90"	90"	90"
Exterior Length	23' 1"	23' 10"	26' 9"	26' 11"	26' 11"
Refrigerator (cu. feet)	6	6	6	6	6
Water Heater Cap. (gal. G/E w/DSI)	6	6	6	6	6
Fresh Water Cap. (gal.)	40	40	40	40	40
Waste Water Cap. (gal.)	30	24	24	24	31
Gray Water Cap. (gal.)	31	31	30	31	31
LP Gas Cap. (lbs.)	40	40	40	40	40
Furnace BTUs (1,000s)	20	20	20	20	20
Tire Size	14"	14"	14"	14"	14"
Awning	13'	15'	17'	17'	16'

\*This weight reflects the rolling average unit weight for each model. Your trailer weight will vary according to optional equipment.



## Standards

- 13,500 BTU A/C
- 2 – 20# Gas Bottles w/Bottle Cover
- 3 Burner Range w/Oven
- 4 Stabilizer Jacks
- 6 Cubic Foot Double Door Refrigerator
- 6 Gallon Gas/Electric DSI Water Heater
- Black Tank Flush
- Bumper w/Sewer Hose Storage
- Diamond Plate Rock Guard on Front
- Double Step
- Exterior Shower
- Fenders
- Foot Flush Toilet
- Fully Walk On Roof

- Hard Valances
- Mattress w/Reversible Down Comforter & Headboard
- Jensen® DVD/CD/Stereo/MP3 w/Bluetooth
- LED Light in Pass Thru Storage
- LED Lights Inside & Out
- Lighted Power Awning w/Speakers
- Microwave
- Monitor Panel
- Night Shades
- Pillows on Sofa
- Radius Baggage Doors w/Magnetic Catches
- Radius Overhead Cabinets & Dinette Bases
- Roller Ball Bearing Drawer Glides
- Porch Light by Entry Door

- Power Vent in Bathroom
- Satellite & Cable Hook Up
- Skylight in Kitchen & Bathroom
- Solid Wood Mortise & Tenon Cabinet Doors
- Stainless Steel Appliances
- Tinted Safety Glass Windows
- Ivory Color Infused Gel Fiberglass Sidewalls

## Options

- Aluminum Wheels
- Cotton Cloud Mattress Upgrade
- LED TV w/Swing Arm
- Outside Grill
- Power Tongue Jack
- Spare Tire/Carrier/Cover

Dealer:



**RVIA**



985 N 900 W • Shipshewana, IN 46565  
E-mail [kz@kz-rv.com](mailto:kz@kz-rv.com) • [www.kz-rv.com](http://www.kz-rv.com)

*Due to continual research and advances, manufacturer reserves the right to change specifications, design, price and equipment without notice, and assumes no responsibility for any error in this literature. Some items shown are not included as standard or optional equipment. ©2015KZ | 1/27/16 | 20M*