

ESCAPE

MINI

Ultra Lightweight Travel Trailers



2017 Décor



Boulder



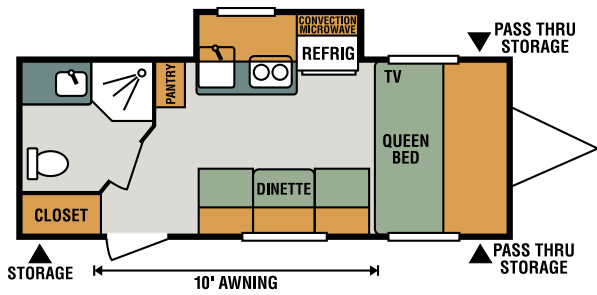

M181KS **NEW**

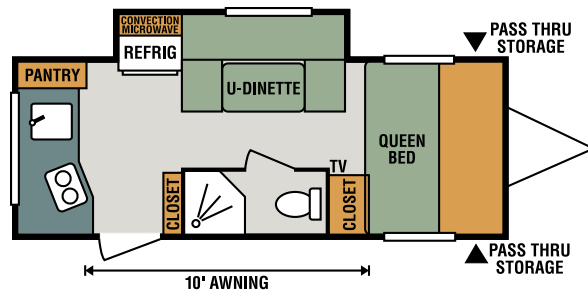

M181RK **NEW**

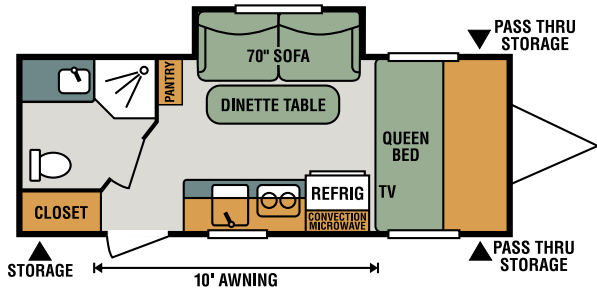

M181SS **NEW**

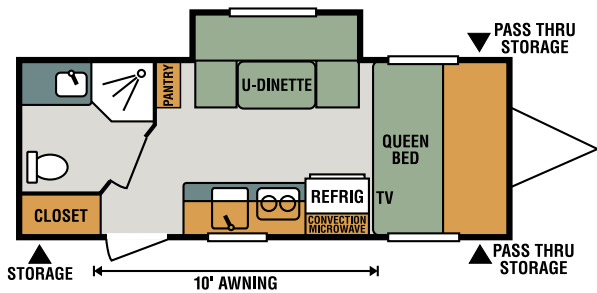

M181UD **NEW**

Travel Trailers	M181KS	M181RK	M181SS	M181UD
UVW (Unloaded Vehicle Weight)*	2,828	2,888	2,848	TBD
Dry Hitch Weight*	300	310	310	TBD
Dry Axle Weight*	TBD	TBD	TBD	TBD
NCC (Net Carrying Capacity)	672	612	652	TBD
GVWR	3,500	3,500	3,500	3,500
Interior Height	82"	82"	82"	82"
Exterior Height	105"	105"	105"	105"
Exterior Width	96"	96"	96"	96"
Exterior Length	20' 11"	20' 11"	20' 11"	20' 11"
Refrigerator (cu. feet)	4	4	4	4
Water Heater Cap. (gal. G/E w/DSI)	6	6	6	6
Fresh Water Cap. (gal.)	30	30	30	30
Waste Water Cap. (gal.)	30	30	30	30
Gray Water Cap. (gal.)	33	33	33	33
LP Gas Cap. (lbs.)	20	20	20	20
Furnace BTUs (1,000s)	20	20	20	20
Tire Size	14"	14"	14"	14"
Awning	10'	10'	10'	10'

*This weight reflects the rolling average unit weight for each model. Your trailer weight will vary according to optional equipment.

Standards

- Tinted Windows
- R-7 Insulation
- Diamond Plate Rock Guard
- Rear Bumper w/Sewer Hose Storage
- Self-Adjust Electric Brakes
- Radial Tires
- 20# LP Bottle
- 30AMP Detachable Power Cord
- Cable Hookup
- City Water Fill
- Digital TV Antenna
- 12V Converter w/Charger
- Monitor Panel
- Residential Crack-Resistant Armstrong® Linoleum
- 2-Burner Cooktop

- Amish-Crafted Rustic Maple-Glazed Cabinets
- Rail-Style Cabinet Doors w/Modern Handles
- Mesh Storage Pockets
- Overhead Cabinets
- LED Interior Lighting
- Shower & Toilet
- Evergreen Queen Mattress w/Reversible Comforter
- Deep Single Sink (large enough for filling pots, pans & pitchers)
- Easy to Tow (no mirror extenders w/our narrow body design)
- Wheels are mounted on the outside of the exterior walls

K-Z Advantage Package (Mandatory Options)

EXTERIOR

- One-Piece Seamless Fiberglass Roof w/Aluminum Rafters
- 5/8" Tongue & Groove Plywood
- Power Awning w/LED Light Strip
- Key-Alike Program for Baggage & Entry Doors
- Maxx Air® Multi-Speed Power Fan
- A/C Prep
- Electric Tongue Jack
- Folding Grab Handle
- Spare Tire & Carrier
- Exterior Speakers
- Outside Shower

- Black Tank Flush
- Solar Prep
- Backup Camera Prep
- (4) Scissor-Style Stabilizer Jacks
- Aluminum Rims
- Nitrogen-Filled Tires

INTERIOR

- 20,000 BTU Furnace
- 6 GAL LP/Electric DSI Water Heater
- Reversible Comforter
- 4.2 CU FT LP/Electric Refrigerator
- Convection Microwave
- Shower Surround w/Fabric Shower Curtain
- Plywood Bed Base
- Seamless Countertops
- (2) 6 1/2" Interior Speakers

- Digital Media Stereo w/Bluetooth & NFC USB Port
- Foot-Flush Toilet
- 12V Dual USB Port

Options

- 13.5K BTU low profile A/C
- 24" LED TV w/inside/outside bracket
- Wireless backup camera system
- Front window

Off-Road Package

- 15" mud tires
- Extra ground clearance
- Electronically controlled heated holding tanks
- Double entry step



985 N 900 W • Shippshewana, IN 46565
E-mail kz@kz-rv.com • www.kz-rv.com

Due to continual research and advances, manufacturer reserves the right to change specifications, design, price and equipment without notice, and assumes no responsibility for any error in this literature. Some items shown are not included as standard or optional equipment. ©2017KZ | 7/10/17 | 10M