



RECREATIONAL
VEHICLES

SPORTSTER

TRAVEL TRAILER & FIFTH WHEEL TOY HAULERS



KEY FEATURES:

- Solar roof prep
- Climate package including insulated, heated, & enclosed underbelly
- 102" wide body
- KZ Engage: Powered by One Control
- Equa-Flex suspension



The KZ **TRUE 2 WARRANTY** is a 2-year hitch-to-bumper limited warranty that's true to its name. The gold standard in RV protection, True 2 provides double the coverage of the industry norm. Plus, our warranty is backed by the craftsmanship and quality we're known for, so you can Go. Camp. Live. Wherever your adventure takes you, know that you're covered in your KZ.



2023 SPORTSTER TOY HAULERS

TRAVEL TRAILER TOY HAULERS

270THR

UVW - 6,600
Exterior Length - 30' 8"
Sleeps - 4

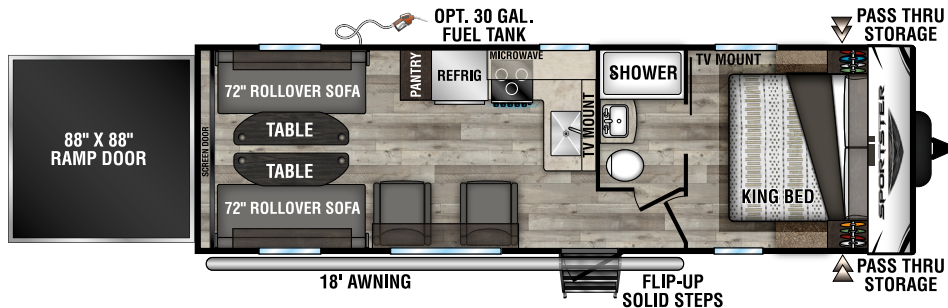

301THR

UVW - 8,070
Exterior Length - 35' 10"
Sleeps - 8

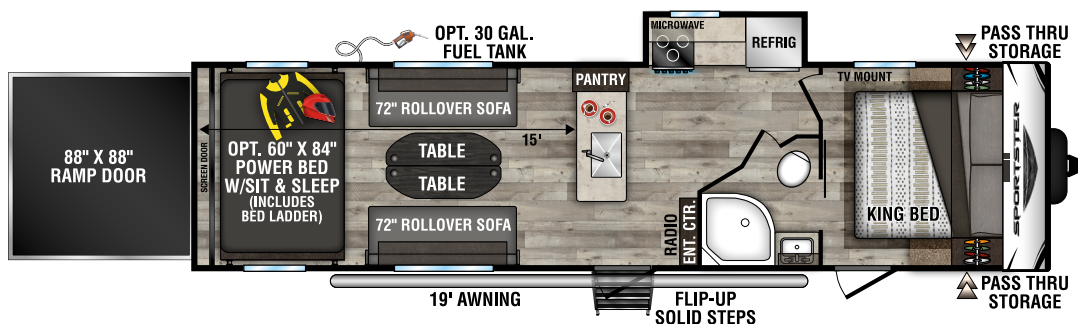

FIFTH WHEEL TOY HAULERS

280TH

UVW - 8,100
Exterior Length - 32' 6"
Sleeps - 7

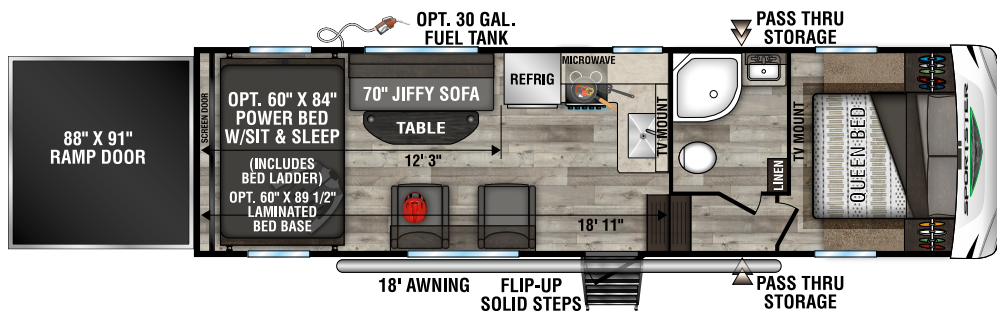

311TH10

UVW - 8,810
Exterior Length - 34'
Sleeps - 7

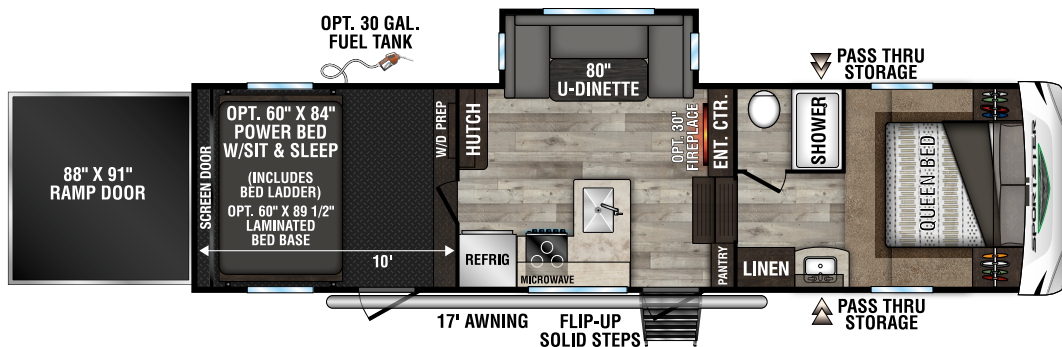

2023 SPORTSTER TOY HAULERS

FIFTH WHEEL TOY HAULERS

331TH13

UVW - 9,780
Exterior Length - 38' 6"
Sleeps - 8

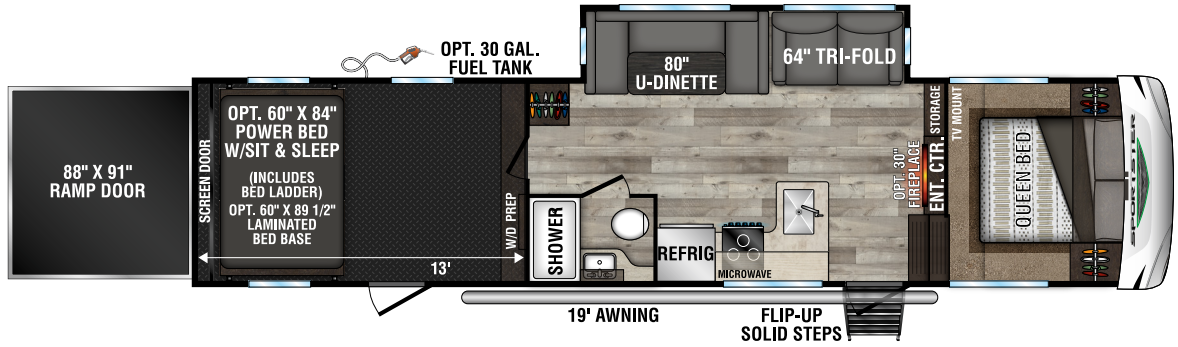

353TH13

UVW - 10,970
Exterior Length - 40' 6"
Sleeps - 6

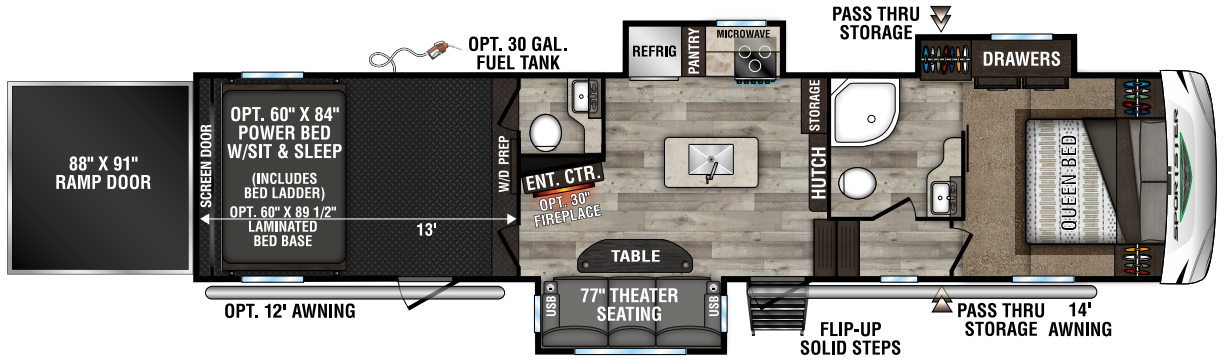

2022 DÉCOR



GUNMETAL



PEBBLE

TRAVEL TRAILERS

FIFTH WHEELS

| Sportster Toy Haulers | 270THR | 301THR | 280TH | 311TH10 | 331TH13 | 353TH13 |
|------------------------------------|--------|---------|--------|---------|---------|--------------|
| UVW (Unloaded Vehicle Weight)* | 6,600 | 8,070 | 8,100 | 8,810 | 9,780 | 10,970 |
| Dry Hitch Weight* | 920 | 1,370 | 1,630 | 1,600 | 2,180 | 2,560 |
| Dry Axle Weight* | 5,680 | 6,700 | 6,470 | 7,210 | 7,600 | 8,410 |
| CCC (Cargo Carrying Capacity) | 3,400 | 2,930 | 3,400 | 3,690 | 3,215 | 3,025 |
| GVWR | 10,000 | 11,000 | 11,500 | 12,500 | 12,995 | 13,995 |
| Interior Height | 90" | 90" | 95" | 95" | 95" | 95" |
| Exterior Height w/ A/C | 12' 3" | 12' 3" | 12' 7" | 12' 7" | 12' 7" | 12' 7" |
| Exterior Width | 102" | 102" | 102" | 102" | 102" | 102" |
| Exterior Length** | 30' 8" | 35' 10" | 32' 6" | 34' | 38' 6" | 40' 6" |
| Refrigerator (cu. feet) | 8 | 8 | 8 | 8 | 8 | 8 |
| Water Heater Cap. (gal. G/E w/DSI) | 6 | 6 | 6 | 6 | 6 | 6 |
| Fresh Water Cap. (gal.) | 75 | 75 | 75 | 75 | 75 | 75 |
| Waste Water Cap. (gal.) | 32 | 32 | 50 | 50 | 32 | 82 |
| Gray Water Cap. (gal.) | 32 | 64 | 50 | 50 | 32 | 50 |
| LP Gas Cap. (lbs.) | 40 | 40 | 60 | 60 | 60 | 60 |
| Furnace BTUs (1,000s) | 30 | 30 | 30 | 30 | 30 | 30 |
| Tire Size | 15" | 15" | 16" | 16" | 16" | 16" |
| Awning | 18' | 19' | 18' | 17' | 19' | 14'/12' opt. |

*This weight reflects the rolling average unit weight for each model. Your trailer weight will vary according to optional equipment.

**For travel trailers, exterior length is measured from rear of bumper to leading edge of coupler. For fifth wheels, exterior length is measured from rear of bumper to center of coupler.

2023 SPORTSTER TOY HAULERS

STANDARDS

- 102" Wide Body
- 3/8" Fully Walk-On Roof Decking
- 1-Piece, Seamless, Walk-on, Tufflex Roofing Material w/Lifetime Warranty
- Radius Truss Rafters
- 90" Interior Wall Height (TTs)
- Awning w/Drip Rail & Spouts
- Cargo Tie-Down Rings
- Tuff Ply® in Enclosed Cargo Areas
- (2) 20# LP Bottles w/Cover (TTs)
- (2) 30# LP Bottles (FWs)
- 30 AMP Service
- 13,500 BTU A/C
- (2) or (4) Stabilizer Jacks (F/P specific)
- Enclosed Pin Box (FWs)
- Tinted Safety Glass Windows
- Self-Adjust Brakes
- Cable & Satellite Hookup
- Radius Entry Door
- Extra-Large, Smooth, Screwless Baggage Doors
- Outside Shower (F/P specific)
- LED Light in Pass-Thru Storage
- Winter Bypass Kit
- Built-in Medicine Cabinet w/Mirror in Bathroom
- Shower Surround
- Power Vent in Bathroom
- Flush-Floor Bedroom (FWs)
- Queen Mattress
- Linoleum Throughout
- Roller Ball Bearing Drawer Glides
- Super-Sized Panoramic Slide Room Window
- LED Interior Lighting
- Monitor Panel
- Digital TV Antenna w/Booster
- 3-Burner Cooktop
- Range Hood w/12V Light & Exhaust Fan
- Oven
- Microwave w/Turntable
- Large Overhead Cabinets

NOTE: Options and packages can be found on the website



CLIMATE PACKAGE

Added insulation so you can extend the camping season, with a fully-enclosed, insulated, and heated underbelly to protect tanks and pipes (R-9* sidewalls, R-20* roof, and R-24* floor).

*Calculated R-Value

Sportster's **FUEL STATION** includes a 30-gallon fuel tank and pump station, and is part of the Generator Prep option.



GENERATOR STORAGE
Optional 4.0 or 5.5 generator



KZ ENGAGE is powered by OneControl with a 5" screen. The control system monitors tank and battery levels, controls the sliderooms, leveling system, awnings, and inside/outside lighting.



OPTIONAL PARTY PATIO PACKAGE railing makes the perfect entertainment extension, by allowing you to get the most use out of the rear ramp.



OUTSIDE SHOWER with hot and cold faucets.

Dealer:

RVIA



KZ RECREATIONAL VEHICLES

985 N 900 W SHIPSEWANA, IN 46565

E: KZ@KZ-RV.COM

WWW.KZ-RV.COM

Due to continual research and advances, manufacturer reserves the right to change specifications, design, price, and equipment without notice, and assumes no responsibility for any error in this literature. Some items shown are not included as standard or optional equipment.

©2022KZ | 00/00/22 | 00M