



RECREATIONAL  
VEHICLES

# SPORTSMEN SELECT

VALUE PACKED TRAVEL TRAILERS



Experience the open road with the Sportsmen Select—a budget-friendly travel trailer packed with premium features like a tankless water heater and sleek stainless steel kitchen, tailored for first-time campers and those seeking unbeatable value.



# 2024 SPORTSMEN SELECT TRAVEL TRAILERS

## KZ ADVANTAGE PACKAGE (mandatory)

- 42,000 BTU Tankless Hot Water Heater
- Power Tongue Jack
- Aerodynamic Front Profile w/Smooth Metal Front
- Black Tank Flush
- Two Toned Exterior Metal
- Full Glass Friction Hinged Entry Door w/Shade Prep, Screenshot & Screen Defender
- Key-Alike Program for Entry & Baggage Doors
- Nitrogen Filled Tires
- (4) Stabilizer Jacks
- Backup Camera Prep
- Solar Roof Prep
- Battery Disconnect
- Leash Latch w/Bonus Beverage Opener
- RV Airflow A/C System w/Air Filter
- Large Folding Grab Handle
- Beauflor Flooring in Slideouts
- Lithium Ready Converter
- Jackknife Sofa w/Center Console & Built-in Bolster Arms
- Bedroom Shirt Closet Shelves w/Charging Stations
- Drop-in 2-Burner Cooktop w/Glass Cover
- (2) 12V USB Ports in Bedroom
- Shower Pan
- Seamless Countertops w/Deep Undermount Stainless Steel Kitchen Sink
- Foot Flush Toilet
- Multi-Media Sound Bar Stereo w/Bluetooth, HDMI & USB Charge
- Wider Pocket/Passage Interior Doors

## KZ CONVENIENCE PACKAGE (mandatory)

- Power Awning
- Magnetic Catches for Baggage Doors
- Battery Disconnect Switch
- Omnidirectional HDTV Antenna w/Wi-Fi Prep
- Residential Grade Linoleum
- 10 CU FT Refrigerator 12V w/Dual Temperature Control
- Black Residential Kitchen Faucet
- Interior Control Switches on Overhead End Cabinet w/Convenience Center for Switches
- Electric Outlet in Bunk Area
- Microwave

*NOTE: Options can be found on the website*

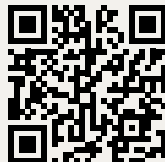

Dealer:

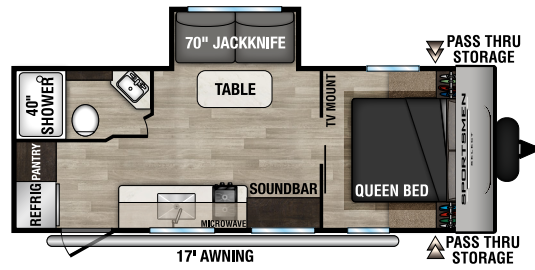

**NEW**

**221RKSL** UVW - 4,900 | Exterior Length - 25' 8" | Sleeps - 4

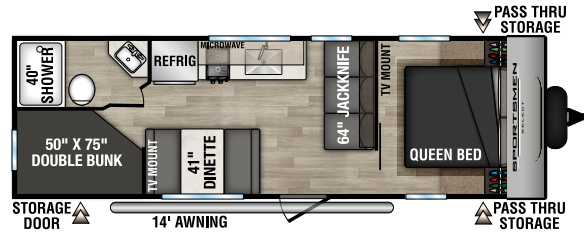

**NEW**

**260BHSL** UVW - 4,760 | Exterior Length - 28' 7" | Sleeps - 7

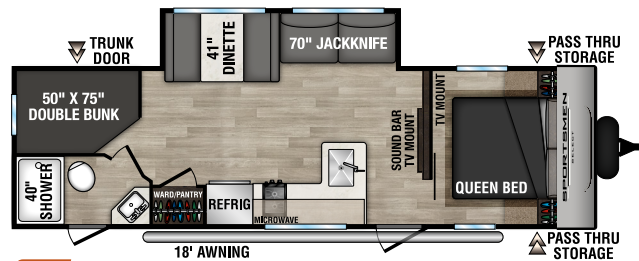

**NEW**

**261BHSL** UVW - 5,840 | Exterior Length - 31' 7" | Sleeps - 9

Value Packed Travel Trailers	221RKSL	260BHSL	261BHSL
UVW (Unloaded Vehicle Weight)*	4,900	4,760	5,840
Dry Hitch Weight**	550	660	830
Dry Axle Weight*	4,350	4,100	5,010
CCC (Cargo Carrying Capacity)	2,100	2,240	1,160
GVWR	7,000	7,000	7,000
Interior Height	TBD	78"	78"
Exterior Height w/ A/C	TBD	10' 8"	10' 8"
Exterior Width	TBD	96"	96"
Exterior Length**	25' 8"	28' 7"	31' 7"
Refrigerator (cu. feet)	TBD	TBD	TBD
Water Heater Cap. (on-demand tankless)	***	***	***
Fresh Water Cap. (gal.)	45	45	45
Waste Water Cap. (gal.)	32	32	32
Gray Water Cap. (gal.)	32	32	32
LP Gas Cap. (lbs.)	40	40	40
Furnace BTUs (1,000s)	TBD	TBD	TBD
Tire Size	14"	14"	14"
Awning	17'	14'	18'

\*This weight reflects the rolling average unit weight for each model. Your trailer weight will vary according to optional equipment.

\*\*Exterior length is measured from rear of bumper to leading edge of coupler.

\*\*\*Infinite supply.



985 N 900 W SHIPSEWANA, IN 46565

E: KZ@KZ-RV.COM

WWW.KZ-RV.COM

Due to continual research and advances, manufacturer reserves the right to change specifications, design, price, and equipment without notice, and assumes no responsibility for any error in this literature. Some items shown are not included as standard or optional equipment.

©2023KZ | 12/01/23 | web