



RECREATIONAL  
VEHICLES

# SPORTSTER

TRAVEL TRAILER & FIFTH WHEEL TOY HAULERS



331TH13 | Gunmetal décor

## KEY FEATURES:

- Solar roof prep
- Climate package including insulated, heated, & enclosed underbelly
- 102" wide body
- KZ Engage: Powered by One Control
- Equa-Flex suspension



The KZ **TRUE 2 WARRANTY** is a 2-year hitch-to-bumper limited warranty that's true to its name. The gold standard in RV protection, True 2 provides double the coverage of the industry norm. Plus, our warranty is backed by the craftsmanship and quality we're known for, so you can Go. Camp. Live. Wherever your adventure takes you, know that you're covered in your KZ.



# 2024 SPORTSTER TRAVEL TRAILER TOY HAULERS

**270THR**  
 UVW - 6,840  
 Exterior Length - 30' 8"  
 Sleeps - 4

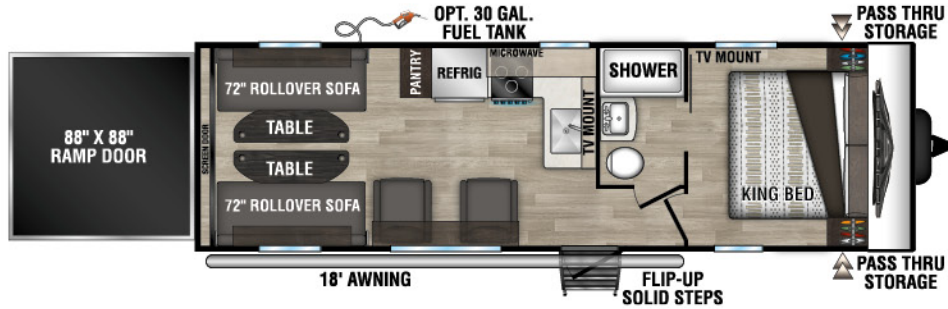

**301THR**  
 UVW - 8,220  
 Exterior Length - 35' 10"  
 Sleeps - 8

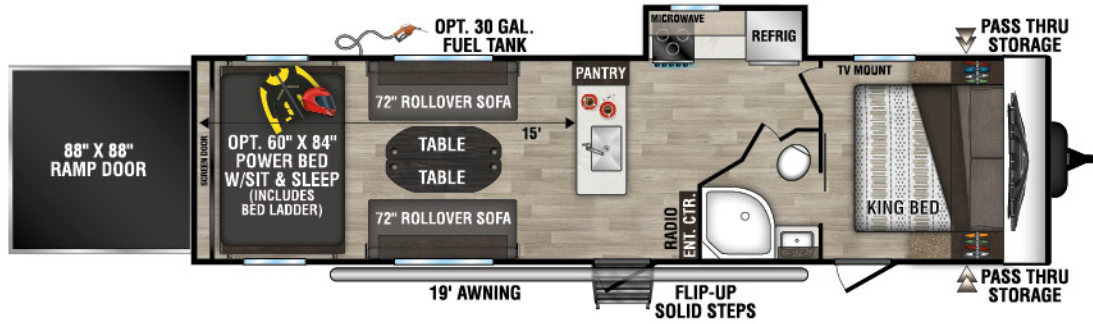

## 2024 DÉCOR



### TRAVEL TRAILERS

### FIFTH WHEELS

Sportster Toy Haulers	270THR	301THR	280TH	331TH13	353TH13
UVW (Unloaded Vehicle Weight)*	6,840	8,220	8,310	9,800	11,070
Dry Hitch Weight*	980	1,380	1,680	2,300	2,640
Dry Axle Weight*	5,860	6,840	6,630	7,500	8,430
CCC (Cargo Carrying Capacity)	3,160	2,780	3,190	3,195	2,925
GVWR	10,000	11,000	11,500	12,995	13,995
Interior Height	90"	90"	95"	95"	95"
Exterior Height w/ A/C	12' 3"	12' 3"	12' 7"	12' 7"	12' 7"
Exterior Width	102"	102"	102"	102"	102"
Exterior Length**	30' 8"	35' 10"	32' 6"	38' 6"	40' 6"
Refrigerator (cu. feet)	8	8	8	8	8
Water Heater Cap. (on-demand tankless)	***	***	***	***	***
Fresh Water Cap. (gal.)	75	75	75	75	75
Waste Water Cap. (gal.)	32	32	50	32	82
Gray Water Cap. (gal.)	32	64	50	32	50
LP Gas Cap. (lbs.)	40	40	60	60	60
Furnace BTUs (1,000s)	30	30	30	30	30
Tire Size	15"	15"	16"	16"	16"
Awning	18'	19'	18'	19'	14'/12' opt.

\*This weight reflects the rolling average unit weight for each model. Your trailer weight will vary according to optional equipment.

\*\*For travel trailers, exterior length is measured from rear of bumper to leading edge of coupler. For fifth wheels, exterior length is measured from rear of bumper to center of coupler.

\*\*\*Infinite supply.

# 2024 SPORTSTER FIFTH WHEEL TOY HAULERS

**280TH**  
 UUV - 8,310  
 Exterior Length - 32' 6"  
 Sleeps - 7

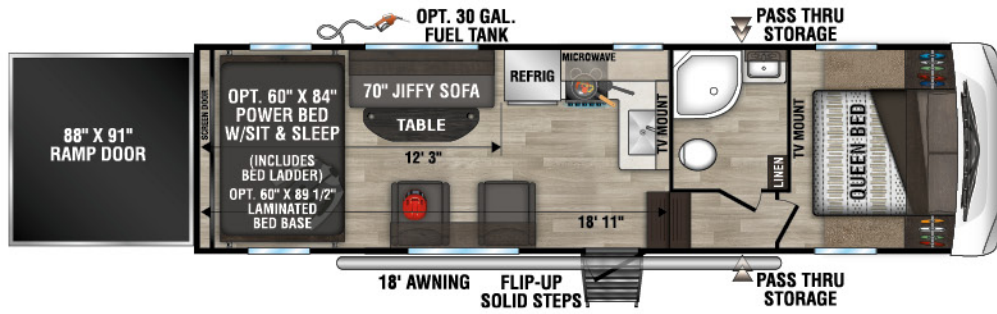

**331TH13**  
 UUV - 9,800  
 Exterior Length - 38' 6"  
 Sleeps - 8

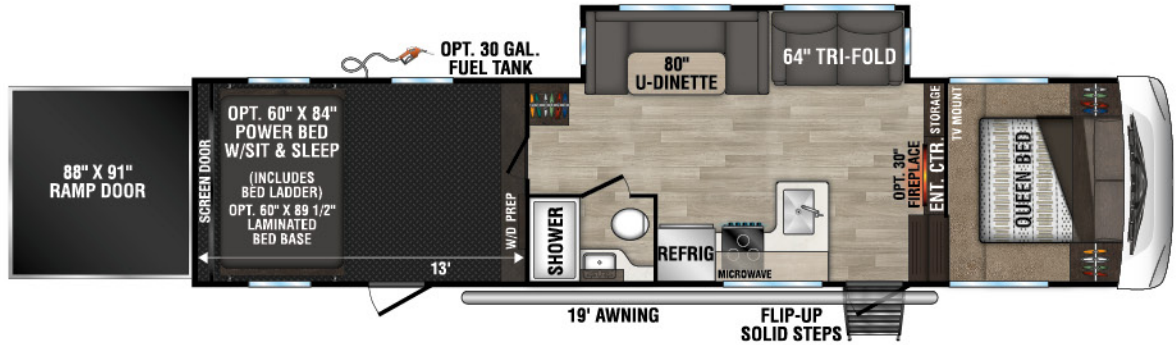

**353TH13**  
 UUV - 11,070  
 Exterior Length - 40' 6"  
 Sleeps - 6



331TH13 | Gummetal decor

# 2024 SPORTSTER TOY HAULERS

## STANDARDS

- 102" Wide Body
- 3/8" Fully Walk-On Roof Decking
- 1-Piece, Seamless, Walk-on, Tufflex Roofing Material w/Lifetime Warranty - More Info
- Radius Truss Rafters
- 90" Interior Wall Height (TTs)
- Awning w/Drip Rail & Spouts
- Cargo Tie-Down Rings
- Tuff Ply® in Enclosed Cargo Areas
- (2) 20# LP Bottles w/Cover (TTs)
- (2) 30# LP Bottles (FWs)
- 30 AMP Service
- 13,500 BTU A/C
- (2) or (4) Stabilizer Jacks (F/P specific)
- Enclosed Pin Box (FWs)
- Tinted Safety Glass Windows
- Self-Adjust Brakes
- Cable & Satellite Hookup
- Radius Entry Door
- Extra-Large, Smooth, Screwless Baggage Doors
- Outside Shower (F/P specific)
- LED Light in Pass-Thru Storage
- Winter Bypass Kit
- Built-in Medicine Cabinet w/Mirror in Bathroom
- Shower Surround
- Power Vent in Bathroom
- Flush-Floor Bedroom (FWs)
- Queen Mattress
- Linoleum Throughout
- Roller Ball Bearing Drawer Glides
- Super-Sized Panoramic Slide Room Window
- LED Interior Lighting
- Monitor Panel
- Digital TV Antenna w/Booster
- 3-Burner Cooktop
- Range Hood w/12V Light & Exhaust Fan
- Oven
- Microwave w/Turntable
- Large Overhead Cabinets

NOTE: Options and packages can be found on the website



Sportster's **FUEL STATION** includes a 30-gallon fuel tank and pump station, and is part of the Generator Prep option.



**OPTIONAL PARTY PATIO PACKAGE** railing makes the perfect entertainment extension, by allowing you to get the most use out of the rear ramp.

## CLIMATE PACKAGE



Added insulation so you can extend the camping season, with a fully-enclosed, insulated, and heated underbelly to protect tanks and pipes (R-9\* sidewalls, R-20\* roof, and R-24\* floor).

\*Calculated R-Value

## GENERATOR STORAGE

Optional 4.0 or 5.5 generator



**KZ ENGAGE** is powered by OneControl with a 5" screen. The control system monitors tank and battery levels, controls the sliderooms, leveling system, awnings, and inside/outside lighting.

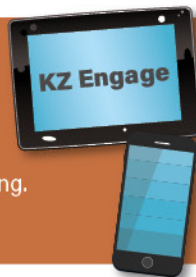

**OUTSIDE SHOWER** with hot and cold faucets.

Dealer:

**RVIA**



**KZ RECREATIONAL VEHICLES**

985 N 900 W SHIPSEWANA, IN 46565

E: KZ@KZ-RV.COM

WWW.KZ-RV.COM

Due to continual research and advances, manufacturer reserves the right to change specifications, design, price, and equipment without notice, and assumes no responsibility for any error in this literature. Some items shown are not included as standard or optional equipment.

©2023KZ | 11/29/23 | web